



City of Chicago



Or2015-224

Office of the City Clerk

Document Tracking Sheet

Meeting Date:	4/15/2015
Sponsor(s):	Moreno (1)
Type:	Order
Title:	Issuance of permits for sign(s)/signboard(s) at 1735 N Ashland Ave - 400 sq. ft.
Committee(s) Assignment:	Committee on Zoning, Landmarks and Building Standards

Committee on Zoning, Landmarks and Building Standards

ORDERED, That the Commissioner of Buildings is hereby directed to issue a sign permit to:

Lincoln Services, Inc.
P.O. Box 64479
Chicago, IL 60664

For the erection of a sign/signboard over 24 feet in height and/or over 100 square feet (in area of one face) at:

1735 N. Ashland

Dimensions: Length 20' 2"; Height 19' 10"
Height above grade / roof to top of sign: 32 feet
TOTAL SQUARE FOOT AREA: 400 sq feet

Such sign(s) shall comply with all applicable provisions of Title 17 of the Chicago Zoning Ordinance and all other applicable provisions of the Municipal Code of the City of Chicago governing the construction and maintenance of outdoor signs, signboards and structures.

1735 N. Ashland
(Application No. 100588581)

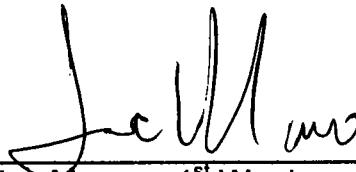

Ald. Proco Joe Moreno, 1st Ward



CITY OF CHICAGO

DEPARTMENT OF BUILDINGS**Sign Permit Application**

APPROVAL NUMBER	APPLICATION NUMBER 100588581	ANNUAL FEE	WORK CODE	DRAWINGS ATTACHED <input type="checkbox"/> YES <input type="checkbox"/> NO			
DATE OF APPLICATION 04/03/2015		TYPE OF SIGN FLAT OR BOX					
ADDRESS OF SIGN 1735 N ASHLAND AVE, 60622-		LENGTH	FT 20	IN. 2	HEIGHT	FT 19	IN. 10
BUILDING	ORIGINAL PERMIT NUMBER		AREA	SQ. FT 400	WEIGHT	LBS. 50	
TYPE OF PERMIT NEW CONSTRUCTION (SIGN)		SIGN HEIGHT ABOVE GRADE/ROOF			FT. 32		
PAYER OF ANNUAL INSPECTION LIMITED PARTNERSHIP, 1735 N. ASHLAND 2734 W. SUPERIOR ST CHICAGO, IL 60612 (773)227-9200		SHAPE OF SIGN REGULAR					
SIGN MANUFACTURER BILLBOARDS, INC		SIGN WILL READ WINTRUST					
ADDRESS WHERE SIGN CAN BE SEEN PRIOR TO ERECTION		NO. OF LAMPS		TOTAL WATTAGE			
		TYPE OF LAMP					
		NO. OF BALLAST/TRANSFORMERS		INPUT OF TRANSFORMERS			
TICKET NUMBER 0		REINSPECTION CONTROL NUMBER		CONTRACTOR WILL INSTALL <input checked="" type="checkbox"/> FEEDERS <input checked="" type="checkbox"/> CUSTOMER LEADS			
TYPE OF SUPPORT FOR SIGN BUILDING		TYPE OF SWITCH					
SIGN BOARD SUPPORT MEMBERS STEEL		LOCATION OF SWITCH					
ANNUAL FEE		SIGN LOCATION ERECT BUSINESS IDENTIFICATION SIGN ON NORTH ELEVATION					
CONSTRUCTION FEE 1017 B FEE							
TOTAL FEE							
AMOUNT PAID							
BALANCE DUE							

The undersigned certify that the statements in this application are true and correct and that all work done under the proposed permit will conform to the requirements of the Chicago Municipal Code

ELECT CONTR	REG NO.	BOND NO.	REG NO. N93194
ADDRESS		SIGN ERECTOR LINCOLN SERVICES	SIGNER
SUPERVISOR SIGNATURE		ADDRESS P.O. BOX 64479 CHICAGO IL, 60664	
		SIGNATURE 	

The permit issued on this application will authorize only signs here applied for. If other signs are to be erected they must be covered by additional permits

City of Chicago
Rahm Emanuel, MayorDepartment of Buildings
Felicia Davis, Commissioner

TYPE OF BUSINESS <u>COMMERCIAL</u> Other: _____ Name: _____ LIC #: _____ Renewal Date: _____	SIGN BOND REQUIRED? <input checked="" type="checkbox"/> YES COUNCIL ORDER REQUIRED <input checked="" type="checkbox"/> YES IS SPECIAL PERMISSION REQUIRED FROM CHIEF ELECTRICAL <input type="checkbox"/> YES IF YES, ATTACH LETTER OF REQUEST
Projects Over: <input checked="" type="checkbox"/> Private Property <input checked="" type="checkbox"/> Public Way Grant Permit #: _____ <input type="checkbox"/> Planned Development/Manufacturing PMD/PD#: _____ Zoning District: <u>M1</u> Other: _____	TIME STAMP
TYPE OF SIGN: <input type="checkbox"/> ADVERTISING <input type="checkbox"/> ILLUMINATE <input type="checkbox"/> MOVEABLE <input checked="" type="checkbox"/> BUSINESS <input type="checkbox"/> FLASHING	
TOTAL STREET FRONTAGE OF LOT (IN FEET) <u>288</u>	
TOTAL AREA OF NEW SIGN (SQ.FT.) <u>400</u>	
TOTAL AREA OF ALL SIGNS ON LOT (SQ.FT.) <u>1,106</u>	
HEIGHT OF SIGN ABOVE GRADE (TO TOP) <u>51ft 10in</u>	
DISTANCE OF CURB LINE OUTER EDGE (ft) <u>50</u>	SIGN CLERK
DISTANCE OF STRUCTURE INNER EDGE (ft) <u>50</u>	APPROVED FOR PERMIT
DISTANCE FROM (ft): A. PUBLIC PARK (OVER 10 ACRES) <u>1,000</u> B. EXPRESSWAY (IF LESS THAN 1,000 FT.) <u>50</u> C. RESIDENCE DISTRICT (ADVERTISING SIGNS ONLY) <u>1,000</u>	REMARKS
IF REPLACEMENT SIGN OR CHANGE OF FACE, WHAT DOES THE EXISTING SIGN READ? Original Payee: _____	
Landmark Hold: <input type="checkbox"/> Status: _____	
ZONING (OFFICE USE ONLY)	

CITY OF CHICAGO
DEPARTMENT OF ZONING AND LAND USE PLANNING
SIGN SITE PLAN
(ALL INFORMATION MUST BE COMPLETED AND LEGIBLE)

Site Address: 1735 N. ASHLAND 1 of 2 applications

Sign Company: LINEAR SIGNS Rep Name: WALSH

Phone (312) 545-8628 EXT (Below: Building, streets and location of sign on lot or structure)
North

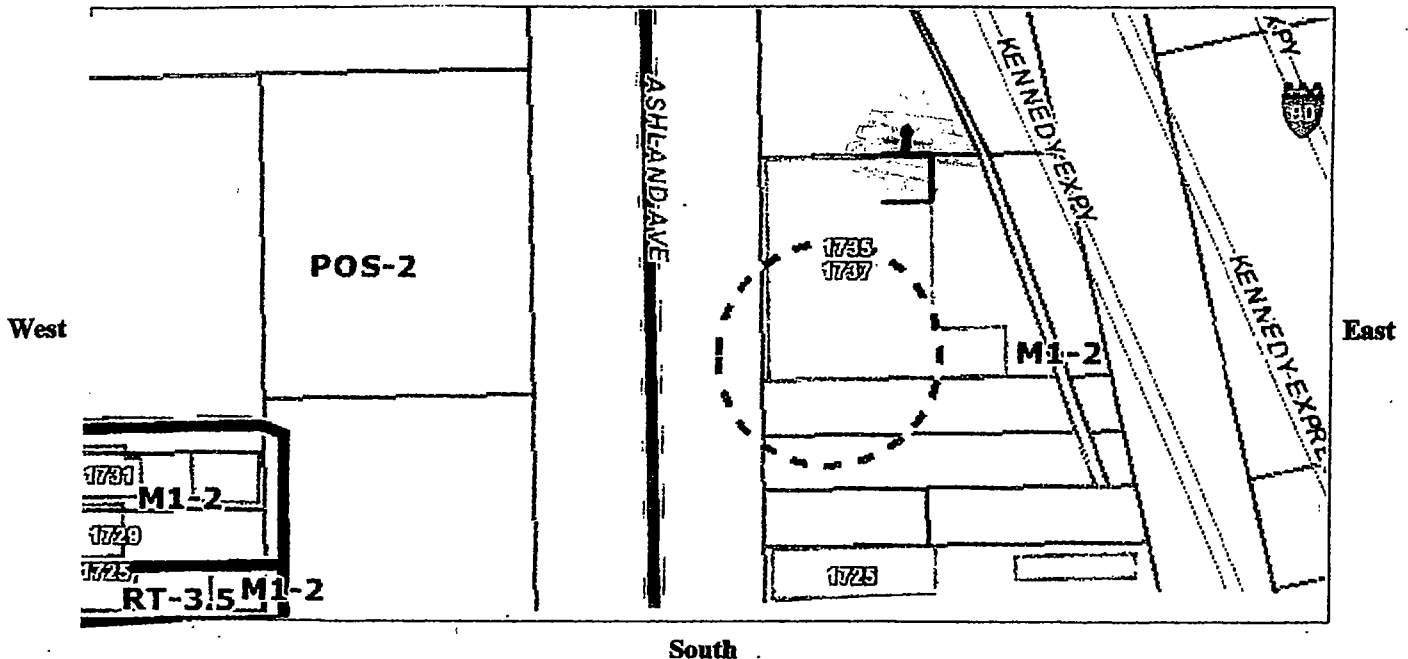

SIGN USE:

Bus. ID (On-premise) ☒

Business Lice. #

BANK EXENAT

Advertising (Off-premise) ☐

PERMIT TYPE:

New Construction ☐

Change of Face

Previous Permit #

358663

TYPE OF SIGN:

Flat Wall ☒

Freestanding ☐

Awning ☐

Marquee ☐

High Rise Building ☐

Projecting Private ☐

Projecting Public Way ☐

Public Way Use -Permit #

SIGN CHARACTERISTICS:

Non- Illuminated ☒

Illuminated ☐

Changing Image ☐

Video Display ☐

Flashing ☐

DISTANCE FROM:

Curb Line: 10'

Expressway, Toll Roads

or Major Route

(n/a if over 1000 ft) 50'

Park (over 10 acres) 1000'

Residential Zone 1000'

Existing Off-premise on

same side of street: 300+

TOTAL SQUARE FOOTAGE:

Square footage of this proposed sign 400'

Gross area of all proposed signs 1106"

Area of all existing signs

(not including proposed) on Zoning Lot 4

Signature: [Signature]

(Revised 4/10)

Date: 1/18/14

EXHIBIT A-2

Drawing of Walls and Upper Area

1735 N. Ashland Mural Building East Face

Exhibit A-2 (Drawings Not To Scale)

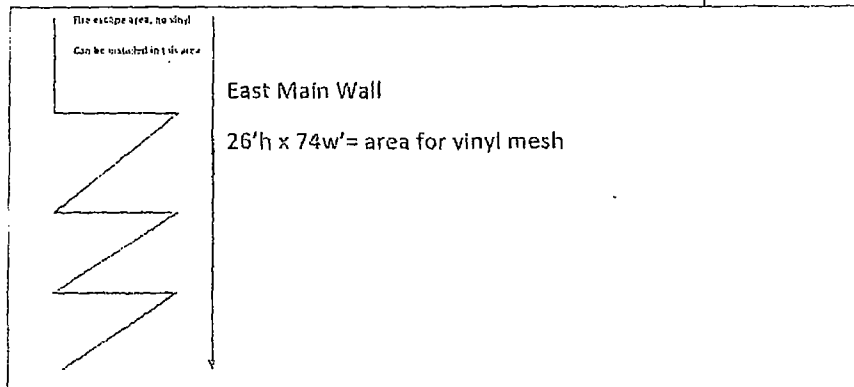
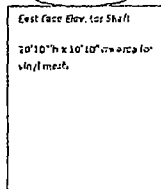
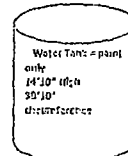

1735 N. Ashland Mural Building North Face

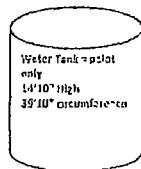

Water Tank on pedestal
only
14'10" high
35'10" circumference

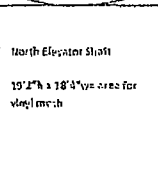

North Elevator Shaft
19'2" h x 18'4" w= area for
vinyl mesh

North Main Wall

27'6" h x 72' w= area for vinyl mesh

1735 N. Ashland Mural Building South Face

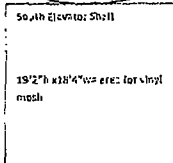
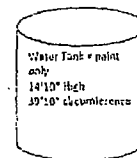

South Main Wall

27'6" h x 72' w = area for vinyl mesh

SUPPLEMENTAL APPLICANT

This Supplemental Application must be completed and submitted along with the Sign Permit Application.
All fields must be completed. If a field is not applicable you must answer "n/a" in the field.

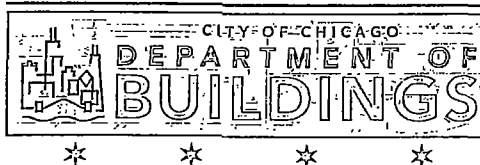

Application Number: 100588581 Date of Application: 4/3/2015

Address of property where sign will be erected: 1735 N. Ashland Ave., Chicago IL

Does property have multiple addresses? ☐ Yes ☒ No

If yes, please list all addresses: _____

Is this building vacant? ☐ Yes ☒ No

If yes, is it registered under the Vacant Building Ordinance? Registration # _____

Section 1 - Applicant

Applicant is the Owner (of the real property) ☒ Lessee (of the real property) ☐

Name of Owner of Real Property: 1735 North Ashland Partners L.P.

Address: 2734 W. Superior St., Chicago IL 60612

Phone #: 773-227-9200 Mobile #: N/A Email: twynn@wynnchicago.com

Name of Lessee of Real Property: Wintrust Financial Corporation

Name: Matt Doubleday Address: 9700 Higgins Rd. Rosemont IL 60018

Phone #: 847-939-9651 Mobile #: N/A Email: mdoubleday@wintrust.com

Section 2 - Contractors

Payer Company of Annual Inspection Fee:

Name of Contact of Payer Company: TED Wynn

Name of Payer Company: 1735 North Ashland Partners Address: 2734 W. Superior St., Chicago IL 60612

Phone #: 773-227-9200 Mobile #: N/A Email: twynn@wynnchicago.com

Electrical Contractor: N/A

Address: _____ License #: _____

Phone #: _____ Mobile #: _____ Email: _____

Website: _____

Sign Erector: Lincoln Services

Bond #: _____ Registration #: N93194

Address: P.O. Box 64479, Chicago IL 60664

Phone #: 312-545-8628 Mobile #: N/A Email: walsh405@sbcglobal.net

Website: N/A

Picture or rendering must be attached depicting sign placement with before and after view. Section 2 continues on next page

CITY OF CHICAGO SIGN PERMIT APPLICATION CONTINUED

Expediter: Lisa Walsh
Address: 3556 S. Seeley, #303 Chicago IL 60609 License #: _____
Phone #: _____ Mobile #: N/A Email: _____
Website: _____

Section 3 - Sign and Structure Details

(Please check all that apply)

Sign Category:

On-Premise (Business ID): ☐ Dynamic ☒ Static

Business License # of Tenant Business: BANK EXEMPT

Off-Premise (Advertising): ☐ Dynamic ☐ Static

Temporary: ☐ Special Event: ☐

Sign will read (Please provide a description, picture and shop drawing): WINTREST

Type of sign (Mark all that apply):

☐ Awning ☐ Canopy ☐ Freestanding ☐ Marquee ☐ Projecting ☐ Dynamic Image Display

☒ Wall ☐ Painted ☐ Cabinet/Frame ☒ Vinyl ☐ Projected image ☐ Flashing

☐ High Rise Building ☐ Hotel/Hospitals ☐ Other buildings: _____

What is the dimension of the wall on which the sign will be installed? _____

Where is sign or sign structure mounted? ☐ Inside the building ☒ Outside the building

Is the sign or sign structure attached to a building or wall? ☒ Yes ☐ No If yes, which wall of building? N E S W

Is this a freestanding sign? ☐ Yes ☒ No Location of sign on lot: N E S W

Which direction does sign copy face? N E S W

Does any portion of the sign, sign structure or attachments cover, obscure or obstruct an existing window in a residential unit whether occupied or not? ☐ Yes ☒ No

Does any portion of the sign, sign structure, or attachments extend on or over the public way? ☐ Yes ☒ No

If yes, what is the public way use permit number? _____

Sign Panels: Back to back within 30 degrees of parallel ☐ Yes ☒ No

Number of Faces: 1

Sign Support Structure: ☐ Pole ☐ Roof ☐ Ground ☒ Building ☐ Windows ☐ Other: _____

Does any portion of the sign or sign structure extend 24 inches above the roof line as defined in 17-17-02149 of the Municipal Code of Chicago? ☐ Yes ☒ No

Picture or rendering must be attached depicting sign placement with before and after view.

Section 3 continues on next page

CITY OF CHICAGO SIGN PERMIT APPLICATION CONTINUED

Section 3 continued

Dimensions of Sign Structure (i.e. cabinet, frame, awning, canopy)

Length: 20 Feet 2 Inches Height: 19 Feet 10 Inches Depth: 0 Feet 1 Inches

Area: 400 Sq Ft. Weight: 50 lbs.

Shape of Sign: Regular

Sign Height above Grade:

From Grade to Bottom of sign or sign structure, whichever is lowest: 32 Ft.

From Grade to Top of sign or sign structure, whichever is highest: 51' 10" Ft.

Is City Council Order required?* ☒ Yes ☐ No

*All signs in excess of 100 Square Feet in area OR in excess of 24 feet above grade require a City Council Order pursuant to Section 13-20-680 of the Municipal Code of Chicago

Dimension of Sign Elements pursuant to Section 17-12-0601 of the Chicago Zoning Ordinance:

Length: 20 Feet 2 Inches Height: 19 Feet 10 inches Area: 400 Sq Ft.

Electrical Contractor will install: Feeders: ☐ Yes ☐ No Customer Leads: ☐ Yes ☐ No

Number of Lamps: _____ Total Wattage: _____ Type of Lamp: N/A

Number of Ballast/Transformers: _____ Input of Transformers: N/A

Type of Switch: _____ Location of Switch: _____

Static: ☒ Yes ☐ No

Illuminated: ☐ Yes ☒ No

If yes - External _____ Internal _____

Dynamic Image Display: ☐ Yes ☒ No

(An affidavit of compliance is required for all dynamic image display signs pursuant to Section 13-20-675(d)(2) of the Municipal Code of Chicago.)

Max Nits _____ Max Foot Candles _____ Message Time (Screen Hold): _____ seconds

Self Dimming Capability: ☐ Yes ☐ No

What is the total of the sign face area devoted to dynamic image display? _____ Sq Ft.

Section 4 - Zoning Information

Zoning District or Planned Development #: M1

Is sign located in a special sign district? ☐ Yes ☒ No

If yes: ☐ Michigan Avenue Corridor ☐ Oak Street Corridor ☐ State Street/Wabash Avenue Corridor

Total Street frontage of Zoning Lot: 288 (Ft.)

Total Area of new sign: 400 (Sq Ft.) Gross Area of all proposed signs: 400 (Sq Ft.)

Total Area of all existing signs on Zoning Lot: 1106 (Sq Ft.)

Picture or rendering must be attached depicting sign placement with before and after view.

Section 4 continues on next page

CITY OF CHICAGO SIGN PERMIT APPLICATION CONTINUED

Section 4 continued

Distance from outer edge of sign or structure to curb line: 50 (Ft.)

Distance from inner edge of sign or sign structure to curb line: 50 (Ft.)

Distance from:

Public Park 10 acres or more: 1000 (Ft.)

Public Park 2 acres or more: 1000 (Ft.)

Expressway or Toll Road: 50 (Ft.)

Lake Shore Drive: N/A (Ft.)

Michigan Avenue (Oak St. to Roosevelt Rd.): N/A (Ft.)

Residential District: 1000 (Ft.)

Residential building in a D district: N/A (Ft.)

Existing off-premise/advertising signs on same side of street? ☒ Yes ☐ No

In a B or C District: N/A (Ft.)

In a D or M District: 300+ (Ft.)

Waterways: N/A (Ft.)

Section 5 - Sign Permit History

Does the proposed sign, change, alter or replace an existing sign? ☐ Yes ☒ No

If yes, were permits issued for the sign being replaced, changed or altered? ☐ Yes ☒ No

If yes, please list each permit number and date each permit was issued:

Permit Number: _____ Date issued: _____

Permit Number: _____ Date issued: _____

Permit Number: _____ Date issued: _____

Permit Number: _____ Date issued: _____

Does the proposed sign change a static sign to a dynamic image display sign? ☐ Yes ☒ No

Does the proposed sign change or alter the square footage or the height of the sign or sign structure? ☐ Yes ☒ No

Does the proposed sign change an on-premise sign to an off-premise/advertising sign? ☐ Yes ☒ No

Section 6 - Attestation and Signatures

We, the undersigned, under penalty of perjury, do hereby affirm and attest that the above information is true, complete, and correct and acknowledge that incorrect information is grounds to revoke or rescind a permit.

Owner of Real Property: [Signature] Date APRIL 2, 2015

Lessee of Real Property: [Signature] Date APRIL 2, 2015

Expediter: [Signature] Date 4/3/15

Supervising Electrician: N/A Date _____

Sign Erector: [Signature] Date 4/3/15

Picture or rendering must be attached depicting sign placement with before and after view.