



City of Chicago



Or2015-226

Office of the City Clerk

Document Tracking Sheet

Meeting Date:	4/15/2015
Sponsor(s):	Moreno (1)
Type:	Order
Title:	Issuance of permits for sign(s)/signboard(s) at 1735 N Ashland Ave - 267 sq. ft.
Committee(s) Assignment:	Committee on Zoning, Landmarks and Building Standards

Committee on Zoning, Landmarks and Building Standards

ORDERED, That the Commissioner of Buildings is hereby directed to issue a sign permit to:

Lincoln Services, Inc.
P.O. Box 64479
Chicago, IL 60664

For the erection of a sign/signboard over 24 feet in height and/or over 100 square feet (in area of one face) at:

1735 N. Ashland

Dimensions: Length 12' 9"; Height 20' 11"
Height above grade / roof to top of sign: 32 feet
TOTAL SQUARE FOOT AREA: 267 sq.. feet

Such sign(s) shall comply with all applicable provisions of Title 17 of the Chicago Zoning Ordinance and all other applicable provisions of the Municipal Code of the City of Chicago governing the construction and maintenance of outdoor signs, signboards and structures.

1735 N. Ashland
(Application No. 100588572)

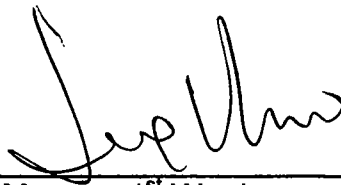

Ald. Proco Joe Moreno, 1st Ward



CITY OF CHICAGO

DEPARTMENT OF BUILDINGS

Sign Permit Application

APPROVAL NUMBER	APPLICATION NUMBER 100588572	ANNUAL FEE	WORK CODE	DRAWINGS ATTACHED <input type="checkbox"/> YES <input type="checkbox"/> NO	
DATE OF APPLICATION 04/03/2015		TYPE OF SIGN FLAT OR BOX			
ADDRESS OF SIGN 1735 N ASHLAND AVE, 60622-		LENGTH 12	FT. 9	HEIGHT 20	IN 11
BUILDING	ORIGINAL PERMIT NUMBER	AREA 267	SQ. FT.	WEIGHT 50	LBS
TYPE OF PERMIT NEW CONSTRUCTION (SIGN)		SIGN HEIGHT ABOVE GRADE/ROOF FT. 32			
PAYER OF ANNUAL INSPECTION LIMITED PARTNERSHIP, 1735 N. ASHLAND 2734 W. SUPERIOR ST CHICAGO, IL 60612 (773)227-9200		SHAPE OF SIGN REGULAR			
SIGN MANUFACTURER BILLBOARDS, INC		SIGN WILL READ WINTRUST			
ADDRESS WHERE SIGN CAN BE SEEN PRIOR TO ERECTION		NO. OF LAMPS TOTAL WATTAGE			
TICKET NUMBER 0		TYPE OF LAMP			
REINSPECTION CONTROL NUMBER		NO. OF BALLAST/TRANSFORMERS INPUT OF TRANSFORMERS			
TYPE OF SUPPORT FOR SIGN BUILDING		CONTRACTOR WILL INSTALL <input checked="" type="checkbox"/> FEEDERS <input checked="" type="checkbox"/> CUSTOMER LEADS			
SIGN BOARD SUPPORT MEMBERS STEEL		TYPE OF SWITCH			
ANNUAL FEE CONSTRUCTION FEE 1017 B FEE TOTAL FEE AMOUNT PAID BALANCE DUE		LOCATION OF SWITCH SIGN LOCATION ERECT BUSINESS IDENTIFICATION SIGN ON EAST ELEVATION			
200.00 200.00 200.00		Check # for Zoning Check # for DCAP			

The undersigned certify that the statements in this application are true and correct and that all work done under the proposed permit will conform to the requirements of the Chicago Municipal Code

REG. NO.	BOND NO.	REG NO	N93194
ELECT CONTR	SIGN ERECTOR LINCOLN SERVICES	SIGNER	
ADDRESS	ADDRESS P.O. BOX 64479 CHICAGO IL, 60664		
SUPERVISOR SIGNATURE	SIGNATURE 		

The permit issued on this application will authorize only signs here applied for. If other signs are to be erected they must be covered by additional permits

City of Chicago
Rahm Emanuel, MayorDepartment of Buildings
Felicia Davis, Commissioner

TYPE OF BUSINESS <u>COMMERCIAL</u> Other: _____ Name: _____ LIC #: <u>BANK EXEMPT</u> Renewal Date: _____ Projects Over: <input checked="" type="checkbox"/> Private Property <input checked="" type="checkbox"/> Public Way Grant Permit #: _____ <input type="checkbox"/> Planned Development/Manufacturing PMD/PD#: _____ Zoning District: <u>M1</u> Other: _____ TYPE OF SIGN: <input type="checkbox"/> ADVERTISING <input type="checkbox"/> ILLUMINATE <input type="checkbox"/> MOVEABLE <input checked="" type="checkbox"/> BUSINESS <input type="checkbox"/> FLASHING TOTAL STREET FRONTAGE OF LOT (IN FEET) <u>288</u> TOTAL AREA OF NEW SIGN (SQ.FT.) <u>267</u> TOTAL AREA OF ALL SIGNS ON LOT (SQ.FT.) <u>1,106</u> HEIGHT OF SIGN ABOVE GRADE (TO TOP) <u>52ft 11in</u> DISTANCE OF CURB LINE OUTER EDGE (ft) <u>50</u> DISTANCE OF STRUCTURE INNER EDGE (ft) <u>50</u> DISTANCE FROM (ft): A. PUBLIC PARK (OVER 10 ACRES) <u>1,000</u> B. EXPRESSWAY (IF LESS THAN 1,000 FT.) <u>50</u> C. RESIDENCE DISTRICT (ADVERTISING SIGNS ONLY) <u>1,000</u> IF REPLACEMENT SIGN OR CHANGE OF FACE, WHAT DOES THE EXISTING SIGN READ? Original Payee: _____ Landmark Hold: <input type="checkbox"/> Status: _____ ZONING (OFFICE USE ONLY)	SIGN BOND REQUIRED? <input checked="" type="checkbox"/> YES COUNCIL ORDER REQUIRED <input checked="" type="checkbox"/> YES IS SPECIAL PERMISSION REQUIRED FROM CHIEF ELECTRICAL <input type="checkbox"/> YES IF YES, ATTACH LETTER OF REQUEST TIME STAMP SIGN CLERK _____ APPROVED FOR PERMIT _____ REMARKS
--	--

SUPPLEMENTAL APPLICANT

This Supplemental Application must be completed and submitted along with the Sign Permit Application.
All fields must be completed. If a field is not applicable you must answer "n/a" in the field.

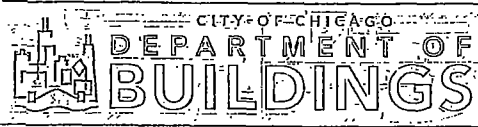

**CITY OF CHICAGO
SIGN PERMIT APPLICATION
(THIS IS NOT A PERMIT)**

Application Number: 100588572 Date of Application: 4/3/15

Address of property where sign will be erected: 1735 N. Ashland Ave., Chicago IL

Does property have multiple addresses? ☒ Yes ☐ No

If yes, please list all addresses: _____

Is this building vacant? ☐ Yes ☒ No

If yes, is it registered under the Vacant Building Ordinance? Registration # _____

Section 1 - Applicant

Applicant is the Owner (of the real property) ☒ Lessee (of the real property) ☐

Name of Owner of Real Property: 1735 North Ashland Partners L.P.

Address: 2734 W. Superior St., Chicago IL 60612

Phone #: 773-227-9200 Mobile #: N/A Email: twynn@wynnchicago.com

Name of Lessee of Real Property: Wintrust Financial Corporation

Name: Matt Doubleday Address: 9700 Higgins Rd. Rosemont IL 60018

Phone #: 847-939-9651 Mobile #: N/A Email: mdoubleday@wintrust.com

Section 2 - Contractors

Payer Company of Annual Inspection Fee:

Name of Contact of Payer Company: TED Wynn

Name of Payer Company: 1735 North Ashland Partners Address: 2734 W. Superior St., Chicago IL 60612

Phone #: 773-227-9200 Mobile #: N/A Email: twynn@wynnchicago.com

Electrical Contractor: N/A

Address: _____ License #: _____

Phone #: _____ Mobile #: _____ Email: _____

Website: _____

Sign Erector: Lincoln Services

Bond #: _____ Registration #: N93194

Address: P.O. Box 64479, Chicago IL 60664

Phone #: 312-545-8628 Mobile #: N/A Email: walsh465@sbeglobal.net

Website: N/A

Picture or rendering must be attached depicting sign placement with before and after view. Section 2 continues on next page

CITY OF CHICAGO SIGN PERMIT APPLICATION CONTINUED

Expediter: Lisa Walsh
Address: 3556 S. Seeley, #303 Chicago IL 60609 Lic:
Phone #: _____ Le #: N/A Email: _____
Website: N/A

Section 3 - Sign and Structure Details

(Please check all that apply)

Sign Category:

On-Premise (Business ID): ☐ Dynamic ☒ Static

Business License # of Tenant Business: BANK EXEMPT

Off-Premise (Advertising): ☐ Dynamic ☐ Static

Temporary: ☐ Special Event: ☐

Sign will read (Please provide a description, picture and shop drawing): Wintrust

Type of sign (Mark all that apply):

☐ Awning ☐ Canopy ☐ Freestanding ☐ Marquee ☐ Projecting ☐ Dynamic Image Display

☒ Wall ☐ Painted ☐ Cabinet/Frame ☒ Vinyl ☐ Projected image ☐ Flashing

☐ High Rise Building ☐ Hotel/Hospitals ☐ Other buildings: _____

What is the dimension of the wall on which the sign will be installed? _____

Where is sign or sign structure mounted? ☐ Inside the building ☒ Outside the building

Is the sign or sign structure attached to a building or wall? ☒ Yes ☐ No If yes, which wall of building? N (E) S W

Is this a freestanding sign? ☐ Yes ☒ No Location of sign on lot: N E S W

Which direction does sign copy face? N (E) S W

Does any portion of the sign, sign structure or attachments cover, obscure or obstruct an existing window in a residential unit whether occupied or not? ☐ Yes ☒ No

Does any portion of the sign, sign structure, or attachments extend on or over the public way? ☐ Yes ☒ No

If yes, what is the public way use permit number? _____

Sign Panels: Back to back within 30 degrees of parallel ☐ Yes ☒ No

Number of Faces: 1

Sign Support Structure: ☐ Pole ☐ Roof ☐ Ground ☒ Building ☐ Windows ☐ Other: _____

Does any portion of the sign or sign structure extend 24 inches above the roof line as defined in 17-17-02149 of the Municipal Code of Chicago? ☐ Yes ☒ No

Picture or rendering must be attached depicting sign placement with before and after view.

Section 3 continues on next page

CITY OF CHICAGO SIGN PERMIT APPLICATION CONTINUED

Section 3 continued

Dimensions of Sign Structure (i.e. cabinet, frame, awning, canopy)

Length: 12 Feet 9 Inches Height: 20 Feet 11 Inches Depth: 0 Feet 1 Inches

Area: 267 Sq Ft. Weight: 50 lbs.

Shape of Sign: Regular

Sign Height above Grade:

From Grade to Bottom of sign or sign structure, whichever is lowest: 32 Ft.

From Grade to Top of sign or sign structure, whichever is highest: 53 Ft.

Is City Council Order required? * ☒ Yes ☐ No

*All signs in excess of 100 Square Feet in area OR in excess of 24 feet above grade require a City Council Order pursuant to Section 13-20-680 of the Municipal Code of Chicago

Dimension of Sign Elements pursuant to Section 17-12-0601 of the Chicago Zoning Ordinance:

Length: 12 Feet 9 Inches Height: 20 Feet 11 inches Area: _____ Sq Ft.

Electrical Contractor will install: Feeders: ☐ Yes ☐ No Customer Leads: ☐ Yes ☐ No

Number of Lamps: _____ Total Wattage: _____ Type of Lamp: N/A

Number of Ballast/Transformers: _____ Input of Transformers: N/A

Type of Switch: _____ Location of Switch: _____

Static: ☒ Yes ☐ No

Illuminated: ☐ Yes ☒ No

If yes - External _____ Internal _____

Dynamic Image Display: ☐ Yes ☒ No

(An affidavit of compliance is required for all dynamic image display signs pursuant to Section 13-20-675(d)(2) of the Municipal Code of Chicago.)

Max Nits _____ Max Foot Candles _____ Message Time (Screen Hold): _____ seconds

Self Dimming Capability: ☐ Yes ☐ No

What is the total of the sign face area devoted to dynamic image display? _____ Sq Ft.

Section 4 - Zoning Information

Zoning District or Planned Development #: M1

Is sign located in a special sign district? ☐ Yes ☒ No

If yes: ☐ Michigan Avenue Corridor ☐ Oak Street Corridor ☐ State Street/Wabash Avenue Corridor

Total Street frontage of Zoning Lot: 288 (Ft.)

Total Area of new sign: 267 (Sq Ft.) Gross Area of all proposed signs: 267 (Sq Ft.)

Total Area of all existing signs on Zoning Lot: 1106 (Sq Ft.)

Picture or rendering must be attached depicting sign placement with before and after view.

Section 4 continues on next page

CITY OF CHICAGO SIGN PERMIT APPLICATION CONTINUED

Section 4 continued

Distance from outer edge of sign or structure to curb line: 50 (Ft.)

Distance from inner edge of sign or sign structure to curb line: 50 (Ft.)

Distance from:

Public Park 10 acres or more: 1000 (Ft.)

Public Park 2 acres or more: 1000 (Ft.)

Expressway or Toll Road: 50 (Ft.)

Lake Shore Drive: 1000 (Ft.)

Michigan Avenue (Oak St. to Roosevelt Rd.): N/A (Ft.)

Residential District: 1000 (Ft.)

Residential building in a D district: N/A (Ft.)

Existing off-premise/advertising signs on same side of street? ☒ Yes ☐ No

In a B or C District: N/A (Ft.)

In a D or M District: 300+ (Ft.)

Waterways: 1000 / N/A (Ft.)

Section 5 - Sign Permit History

Does the proposed sign, change, alter or replace an existing sign? ☐ Yes ☒ No

If yes, were permits issued for the sign being replaced, changed or altered? ☐ Yes ☒ No

If yes, please list each permit number and date each permit was issued:

Permit Number: _____ Date issued: _____

Permit Number: _____ Date issued: _____

Permit Number: _____ Date issued: _____

Permit Number: _____ Date issued: _____

Does the proposed sign change a static sign to a dynamic image display sign? ☐ Yes ☒ No

Does the proposed sign change or alter the square footage or the height of the sign or sign structure? ☐ Yes ☒ No

Does the proposed sign change an on-premise sign to an off-premise/advertising sign? ☐ Yes ☒ No

Section 6 - Attestation and Signatures

We, the undersigned, under penalty of perjury, do hereby affirm and attest that the above information is true, complete, and correct and acknowledge that incorrect information is grounds to revoke or rescind a permit.

Owner of Real Property: [Signature] Date APRIL 2, 2015

Lessee of Real Property: John A. [Signature] Date April 2, 2015

Expediter: [Signature] Date 4/3/15

Supervising Electrician: N/A Date _____

Sign Erector: [Signature] Date 4/3/15

Picture or rendering must be attached depicting sign placement with before and after view.

CITY OF CHICAGO
DEPARTMENT OF ZONING AND LAND USE PLANNING
SIGN SITE PLAN
(ALL INFORMATION MUST BE COMPLETED AND LEGIBLE)

Site Address: 1735 N. ASHLAND 2 of 2 applications

Sign Company: Lincoln Signs Rep Name: Walsh

Phone (312) 545-8628 EXT (Below: Building, streets and location of sign on lot or structure)
North

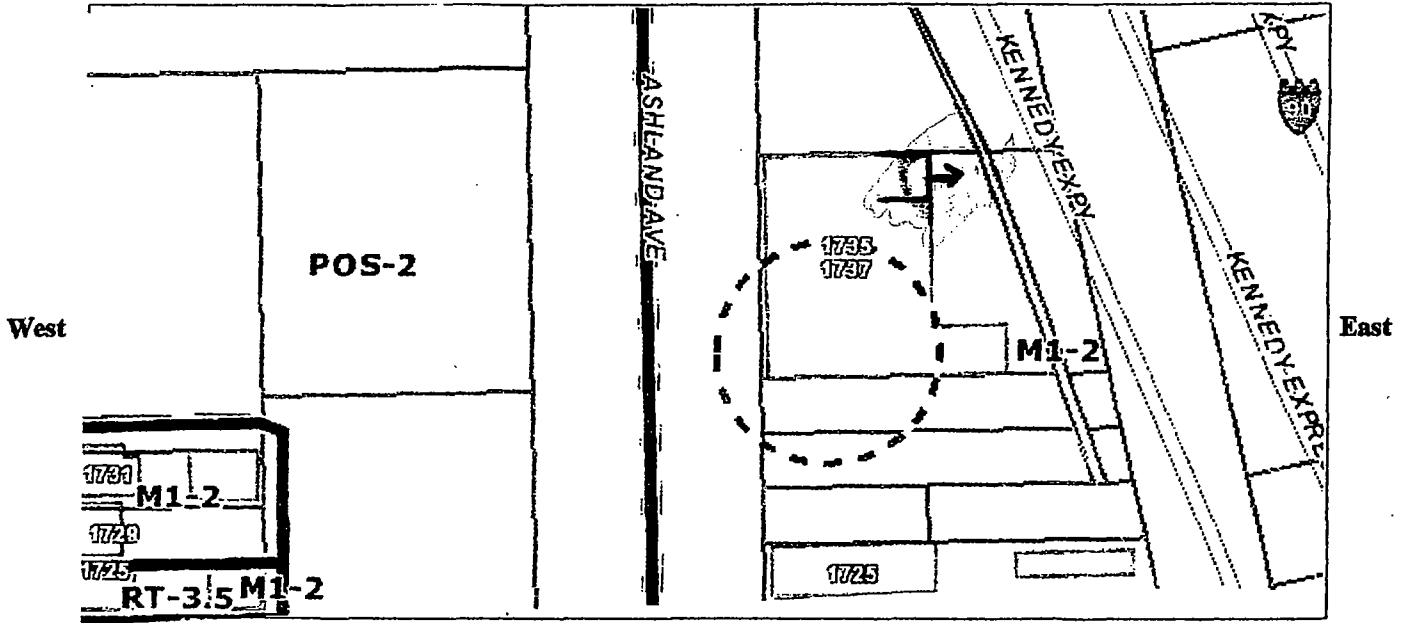

South

SIGN USE:

Bus. ID (On-premise) ☒

Business Lice. #

BANK EXEMPT

Advertising (Off-premise) ☐

PERMIT TYPE:

New Construction ☐

Change of Face

Previous Permit #

TYPE OF SIGN:

Flat Wall ☒

Freestanding ☐

Awning ☐

Marquee ☐

High Rise Building ☐

Projecting Private ☐

Projecting Public Way ☐

Public Way Use -Permit #

SIGN CHARACTERISTICS:

Non- Illuminated ☒

Illuminated ☐

Changing Image ☐

Video Display ☐

Flashing ☐

DISTANCE FROM:

Curb Line: 10'

Expressway, Toll Roads

or Major Route

(n/a if over 1000 ft) 50'

Park (over 10 acres) 1000'

Residential Zone 1000'

Existing Off-premise on

same side of street: 300+

TOTAL SQUARE FOOTAGE:

Square footage of this proposed sign 274'

Gross area of all proposed signs 1106'

Area of all existing signs

(not including proposed) on Zoning Lot 4

Signature: [Signature]

(Revised 4/10)

Date: 1/18/14

1735 N. Ashland, Chicago, IL - The Mural Building

East Face

12' 9"

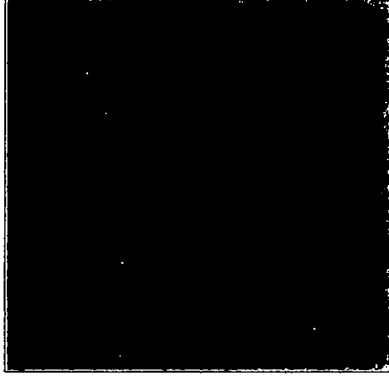

20' 11.75"

■ = on premise identification sign

32'

100'



EAST

Bank America
Neighborhood
Excellence Initiative
1-800-452-2269

DAILY TRAINING SERVICES STUDENT LEADER

Help the Community

EXHIBIT A-2

Drawing of Walls and Upper Area

1735 N. Ashland Mural Building East Face

Exhibit A-2 (Drawings Not To Scale)

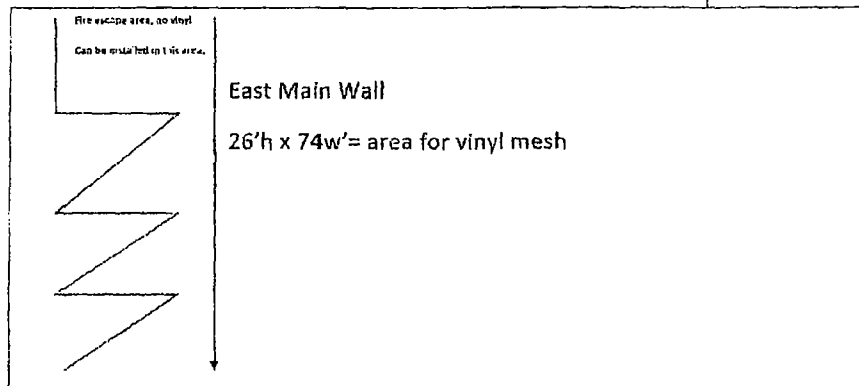
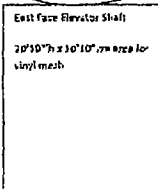
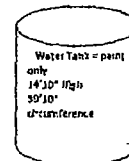

1735 N. Ashland Mural Building North Face

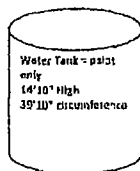

North Elevator Shaft
19'2" h x 18'4" w= area for
vinyl mesh

North Main Wall

27'6" h x 72' w= area for vinyl mesh

1735 N. Ashland Mural Building South Face

