



City of Chicago



O2015-7476

Office of the City Clerk

Document Tracking Sheet

Meeting Date:	10/14/2015
Sponsor(s):	Ervin (28)
Type:	Ordinance
Title:	Grant(s) of privilege in public way for Ogden North LLC - fence - 1256-1260 S Washtenaw Ave
Committee(s) Assignment:	Committee on Transportation and Public Way

ORDINANCE
Ogden North LLC
Acct. No. 350716 - 1
Permit No. 1119019

Be It Ordained by the City Council of the City of Chicago:

SECTION 1. Permission and authority are hereby given and granted to Ogden North LLC, upon the terms and subject to the conditions of this ordinance to maintain and use, as now constructed, one (1) Fence(s) on the public right-of-way adjacent to its premises known as 1256-1260 S. Washtenaw Ave..

Said Fence(s) at 1256-1260 S. WASHTENAW AVENUE measure(s):
One (1) at fifty-five point five five (55.55) feet in length and approximately six (6) feet in height.

The location of said privilege shall be as shown on prints kept on file with the Department of Business Affairs and Consumer Protection and the Office of the City Clerk.

Said privilege shall be constructed in accordance with plans and specifications approved by the Department of Transportation (Division of Project Development).

This grant of privilege in the public way shall be subject to the provisions of Section 10-28-015 and all other required provisions of the Municipal Code of Chicago.

The grantee shall pay to the City of Chicago as compensation for the privilege #1119019 herein granted the sum of four hundred (\$400.00) per annum in advance.

A 25% penalty will be added for payments received after due date.

The permit holder agrees to hold the City of Chicago harmless for any damage, relocation or replacement costs associated with damage, relocation or removal of private property caused by the City performing work in the public way.

Authority herein given and granted for a period of five (5) years from and after 05/12/2015.

Alderman

Jason Ervin 28th Ward

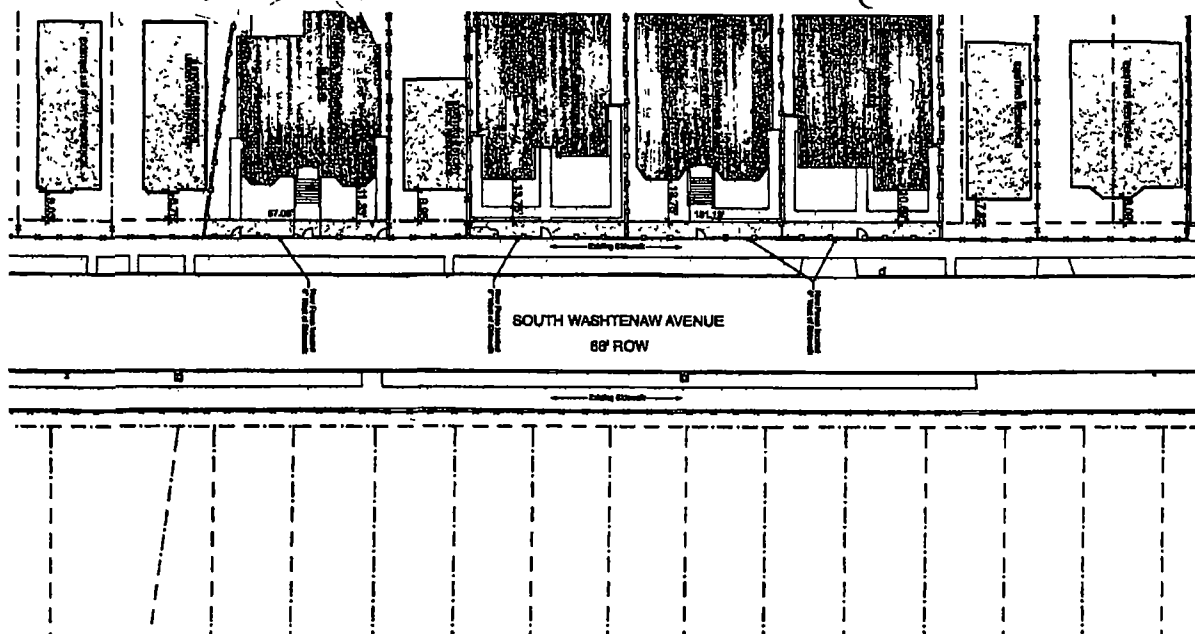

Legend	
Property Line	---
Building Footprint	▬
Area of 100' Front	▬
Proposed/Existing Building	▬
Area of Encroachment in the Public Way	▬

Encroachments Within the Public Way



Scale: 1" = 40'

Prepared by: KOO

Design: KOO

City of Ann Arbor

KOO
City and Associates, LLC
Ann Arbor, MI 48106

Scale: 1" = 40'