



# City of Chicago



Or2019-155

Office of the City Clerk

## Document Tracking Sheet

<b>Meeting Date:</b>	4/10/2019
<b>Sponsor(s):</b>	Reilly (42)
<b>Type:</b>	Order
<b>Title:</b>	Issuance of permits for sign(s)/signboard(s) at 228 E Illinois St
<b>Committee(s) Assignment:</b>	Committee on Zoning, Landmarks and Building Standards

CITY COUNCIL  
COMMITTEE ON ZONING, LANDMARKS AND BUILDING STANDARDS

COUNCIL ORDER

RE: Approval of sign over 100 square feet in area or over 24 feet above grade

ORDERED, that the City Council hereby approves the following sign application submitted by:

Applicant\*: Runaway Fitness

(\* The Applicant is the owner of the real property or the business tenant of the real property. Do not list the sign contractor, sign erector, sign company or advertising entity in the above space.)

This Order approves the following sign in accordance with Municipal Code of Chicago Section 13-20-680:

Address of Sign: 228 E. Illinois Chicago, IL 60611

Zoning District: PD368

DOB Sign Permit Application #: 100809648

Sign Details:

1. On-premise ☒ OR Off-premise ☐
2. Static sign ☒ OR Dynamic-image display sign ☐
3. Number of sign faces 1
4. Projecting over the public way No (Yes or No) If yes, Public Way Use #: \_\_\_\_\_
5. Dimensions: Length 27 feet 8 inches Height 4 feet 7 inches  
Total square feet in area: 128 feet \_\_\_\_\_ inches
6. Height above grade: 5 feet 7 inches
7. Elevation (side of building or lot where the sign will be erected): east
8. Name of Sign Contractor/Erector: Midwest Facilities and Construction, LLC

To be legal, such sign shall comply with all provisions of Title 17 of the Chicago Municipal Code ("Zoning Ordinance") and all other provisions of the Municipal Code governing the permitting, construction and maintenance and removal of signs and sign structures. Failure of the applicant and the applicant's successors to comply shall be grounds for invalidation or revocation of the sign permit.

  
Alderman

  
Ward

# SITE PLAN

GRAND AVE.

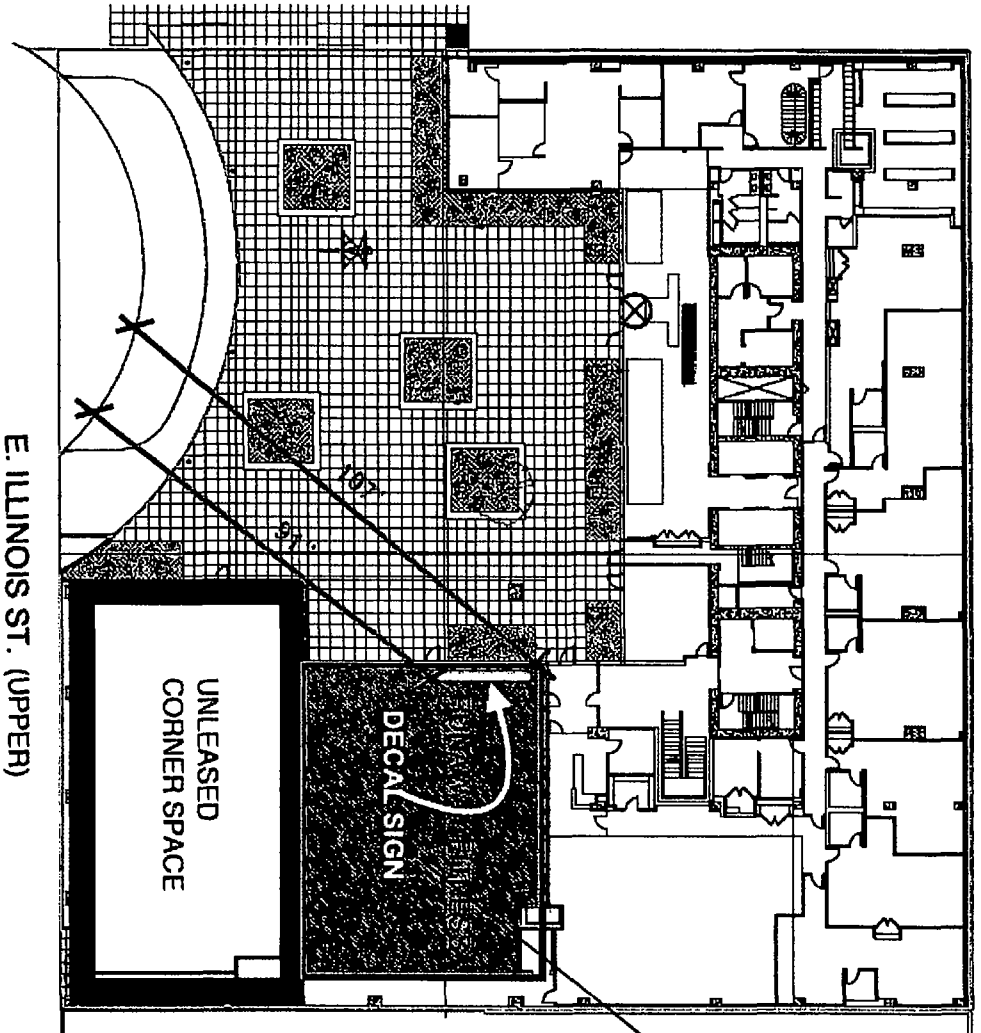

228 E. ILLINOIS ST.  
RUNAWAY FITNESS  
SPACE - 4078 SF

SCALE = 1/32" = 1'-0"

SCALE: 1/2" = 1'-0"

SCALE: 3/4" = 1'-0"

SCALE: 1" = 1'-0"