



# City of Chicago



Or2019-200

Office of the City Clerk

## Document Tracking Sheet

|                                 |  |
|---------------------------------|--|
| <b>Meeting Date:</b>            | 5/29/2019  |
| <b>Sponsor(s):</b>              | Waguespack (32)  |
| <b>Type:</b>                    | Order  |
| <b>Title:</b>                   | Issuance of permits for sign(s)/signboard(s) at 2501 N<br>Damen Ave - northwest corner |
| <b>Committee(s) Assignment:</b> | Committee on Zoning, Landmarks and Building Standards                                  |

CITY COUNCIL  
COMMITTEE ON ZONING, LANDMARKS AND BUILDING STANDARDS

COUNCIL ORDER

RE: Approval of sign over 100 square feet in area or over 24 feet above grade

ORDERED, that the City Council hereby approves the following sign application submitted by:

Applicant\*: CHICK - FIL - A  
(\* The Applicant is the owner of the real property or the business tenant of the real property. Do not list the sign contractor, sign erector, sign company or advertising entity in the above space.)

This Order approves the following sign in accordance with Municipal Code of Chicago Section 13-20-680:

Address of Sign: 2501 N. DAMEN AVE Chicago, IL 606 47

Zoning District: C3-3

DOB Sign Permit Application #: 100814544

Sign Details:

1. On-premise X OR Off-premise \_\_\_\_\_

2. Static sign X OR Dynamic-image display sign \_\_\_\_\_

3. Number of sign faces 2

4. Projecting over the public way \_\_\_\_\_ (Yes or No) If yes, Public Way Use #: \_\_\_\_\_

5. Dimensions: Length 11 feet \_\_\_\_\_ inches Height 11 feet \_\_\_\_\_ inches

Total square feet in area: 121 feet \_\_\_\_\_ inches

6. Height above grade: 25 feet \_\_\_\_\_ inches

7. Elevation (side of building or lot where the sign will be erected): NW CORNER

8. Name of Sign Contractor/Erector: MODERN SIGNS INC

To be legal, such sign shall comply with all provisions of Title 17 of the Chicago Municipal Code ("Zoning Ordinance") and all other provisions of the Municipal Code governing the permitting, construction and maintenance and removal of signs and sign structures. Failure of the applicant and the applicant's successors to comply shall be grounds for invalidation or revocation of the sign permit.

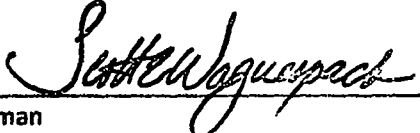
  
Alderman

32  
Ward

City Council  
Meeting Date: \_\_\_\_\_  
Committee on Buildings

(signs)

ORDERED, That the Commissioner of Buildings is hereby directed to  
issue a sign permit to: (Contractor's name and address)

MODERN SIGNS INC

1727 ARMITAGE CT

ADDISON IL 60101

for the erection of a sign / signboard over 24 feet in height and / or over 100  
square feet (in area of one face) at: (Business NAME & ADDRESS)

CHICK - FIL - A

2501 N. DAMEN AVE

CHICAGO IL 60647

Dimensions: Length 11' Height 11'

Height above grade / roof to top of sign 25'

TOTAL SQUARE FOOT AREA 121<sup>sq</sup>

Such sign(s) shall comply with all applicable provisions of TITLE 17 of the  
Chicago Zoning Ordinance and all other applicable provisions of the Municipal  
Code of the City of Chicago governing the construction and maintenance of  
outdoor signs, signboards and structures.

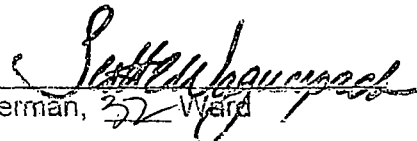
  
Alderman, 32<sup>nd</sup> Ward



CITY OF CHICAGO

# DEPARTMENT OF BUILDINGS

## Aldermanic Acknowledgment Letter

TO: Department of Buildings  
121 North LaSalle Street, Room 900  
Chicago, IL 60602

DATE: 5/3/2019, 20\_\_

I am aware of the application for a building permit at the following address. I have no objection to its issuance.

Address: 2501 N. DAMEN AVE

Date of Application: 4/15/2019

Type of Permit: SIGN

Signed: \_\_\_\_\_

*Scott Waquespack*

SCOTT WAQUESPACK

(Alderman's full name, printed or typed)

Ward: 32

Telephone: (773) 248 1330





CITY OF CHICAGO

## DEPARTMENT OF BUILDINGS

192

## Sign Permit Application

|   |                                 |            |  |  |
|---|---------------------------------|------------|--|--|
| APPROVAL NUMBER   | APPLICATION NUMBER<br>100814544 | ANNUAL FEE | WORK CODE  | DRAWINGS<br>ATTACHED <input type="checkbox"/> YES<br><input type="checkbox"/> NO |
| DATE OF APPLICATION<br>04/15/2019   |                                 |            | TYPE OF SIGN<br>FLAT OR BOX  |  |
| ADDRESS OF SIGN<br>2501 N'DAMEN AVE, 60647-   |                                 |            | LENGTH<br>11   | FT. IN. HEIGHT<br>11   |
| BUILDING  | ORIGINAL PERMIT NUMBER          |            | AREA<br>121  | SQ. FT. WEIGHT<br>300  |
| TYPE OF PERMIT<br>NEW CONSTRUCTION (SIGN)   |                                 |            | SIGN HEIGHT ABOVE GRADE/ROOF<br>FT. 14   |  |
| PAYER OF ANNUAL INSPECTION<br>HILL, JASON<br>5200 BUFFINGTON RD<br>ATLANTA, GA 30349<br>(404)684-8530 |                                 |            | SHAPE OF SIGN<br>REGULAR   |  |
| SIGN MANUFACTURER<br>CLAYTON SIGNS  |                                 |            | SIGN WILL READ<br>CFA LOGO   |  |
| ADDRESS WHERE SIGN CAN BE SEEN PRIOR TO ERECTION  |                                 |            | NO. OF LAMPS<br>12   |  |
| TICKET NUMBER<br>0  |                                 |            | TOTAL WATTAGE<br>100   |  |
| REINSPECTION CONTROL NUMBER   |                                 |            | TYPE OF LAMP<br>FLUORESCENT  |  |
| TYPE OF SUPPORT FOR SIGN<br>POLE  |                                 |            | NO. OF BALLAST/TRANSFORMERS<br>1   |  |
| SIGN BOARD SUPPORT MEMBERS<br>STEEL   |                                 |            | INPUT OF TRANSFORMERS<br>120   |  |
| ANNUAL FEE<br>CONSTRUCTION FEE<br>1017 B FEE<br>TOTAL FEE<br>AMOUNT PAID<br>BALANCE DUE               |                                 |            | CONTRACTOR WILL INSTALL<br><input checked="" type="checkbox"/> FEEDERS<br><input checked="" type="checkbox"/> CUSTOMER LEADS   |  |
| 600.00<br>600.00<br>200.00<br>\$ 400.00   |                                 |            | TYPE OF SWITCH<br>SPECIAL  |  |
| Check # for Zoning  |                                 |            | LOCATION OF SWITCH<br>LISTED FLUSH TOGGLE  |  |
| Check # for DCAP  |                                 |            | SIGN LOCATION<br>INSTALL ILLUMINATED PYLON SIGN FACING<br>EAST/WEST OVER PRIVATE PROPERTY. SWITCH IS<br>PART OF UL SIGN. ZONING ADDRESS IS 1880 W.<br>FULLERTON AVE. |  |

The undersigned certify that the statements in this application are true and correct and that all work done under the proposed permit will conform to the requirements of the Chicago Municipal Code

|   |   |
|---|---|
| LICENSE #<br>E94792                                 | #<br>TGC101520                                      |
| ELECT CONTR*<br>MODERN SIGNS, INC.                  | CONTRACTOR*<br>MODERN SIGNS INC                     |
| ADDRESS<br>1727 ARMITAGE COURT<br>ADDISON, IL 60101 | ADDRESS<br>1727 ARMITAGE COURT<br>ADDISON IL, 60101 |
| SUPERVISOR SIGNATURE<br><i>William F. Kelly</i>     | SIGNATURE<br><i>William F. Kelly</i>                |

\*IF APPLICABLE

The permit issued on this application will authorize only signs here applied for. If other signs are to be erected they must be covered by additional permits.

City of Chicago  
Rahm Emanuel, MayorDepartment of Buildings  
Judith Frydland, Commissioner

|  |  |
|--|--|
| TYPE OF BUSINESS:<br><u>COM DINING</u> Other: <u>RESTAURANT</u><br>Name: <u>CHICK-FIL-A</u><br>LIC #: <u>412351</u><br>Renewal Date: _____   | SIGN BOND REQUIRED? <input type="checkbox"/> YES<br>COUNCIL ORDER REQUIRED <input checked="" type="checkbox"/> YES<br>IS SPECIAL PERMISSION REQUIRED FROM CHIEF ELECTRICAL<br><input type="checkbox"/> YES<br>IF YES, ATTACH LETTER OF REQUEST |
| Projects Over:<br><input checked="" type="checkbox"/> Private Property<br><input checked="" type="checkbox"/> Public Way Grant Permit #: _____<br><input type="checkbox"/> Planned Development/Manufacturing PMD/PD#: _____<br>Zoning District: <u>C3</u> Other: <u>C3-3</u> | TIME STAMP   |
| TYPE OF SIGN:<br><input type="checkbox"/> ADVERTISING <input checked="" type="checkbox"/> ILLUMINATE <input type="checkbox"/> MOVEABLE<br><input checked="" type="checkbox"/> BUSINESS <input type="checkbox"/> FLASHING   |  |
| TOTAL STREET FRONTAGE OF LOT (IN FEET) <u>608</u>  |  |
| TOTAL AREA OF NEW SIGN (SQ.FT.) <u>121</u>   |  |
| TOTAL AREA OF ALL SIGNS ON LOT (SQ.FT.) <u>570</u>   |  |
| HEIGHT OF SIGN ABOVE GRADE (TO TOP) <u>25ft</u> in   |  |
| DISTANCE OF CURB LINE OUTER EDGE (ft) <u>20</u>  | SIGN CLERK   |
| DISTANCE OF STRUCTURE INNER EDGE (ft) <u>31</u>  | APPROVED FOR PERMIT  |
| DISTANCE FROM (ft):<br>A. PUBLIC PARK (OVER 10 ACRES) <u>500</u><br>B. EXPRESSWAY (IF LESS THAN 1,000 FT.) <u>1,000</u><br>C. RESIDENCE DISTRICT (ADVERTISING SIGNS ONLY) <u>50</u>  | REMARKS  |
| IF REPLACEMENT SIGN OR CHANGE OF FACE, WHAT DOES THE EXISTING SIGN READ?<br><br>Original Payee: _____  |  |
| Landmark Hold: <input type="checkbox"/> Status: _____  |  |
| ZONING (OFFICE USE ONLY)   |  |

## SUPPLEMENTAL APPLICATION

This Supplemental Application must be completed and submitted along with the Online Sign Permit Application.  
All fields must be completed. If a field is not applicable you must answer "n/a" in the field. A2



# CITY OF CHICAGO SIGN PERMIT APPLICATION (THIS IS NOT A PERMIT)

Application Number: 100814544 Date of Application: 04/15/2019

Address of property where sign will be erected: 2501 N. Damen Ave. 60647

Does property have multiple addresses? ☒ Yes ☐ No

If yes, please list all addresses: Zoning address is 1880 W. Fullerton Ave.

Is this building vacant? ☐ Yes ☒ No

If yes, is it registered under the Vacant Building Ordinance? Registration # \_\_\_\_\_

## Section 1 - Applicant

Applicant is the Owner (of the real property) ☐ Lessee (of the real property) ☐ Sign Erector

Name of Owner of Real Property: Vienna Beef, LTD.

Address: 2501 N. Damen Ave. Chicago, IL 60647

Phone #: 773-278-7800 Mobile #: \_\_\_\_\_ Email: jpbod@viennabeef.com

Name of Lessee of Real Property: Chick-fil-a

Name: Jason Hill Address: 5200 Buffington Rd. Atlanta, GA 30349

Phone #: 404-684-8530 Mobile #: \_\_\_\_\_ Email: jhill@cfa.com

## Section 2 - Contractors

Payer Company of Annual Inspection Fee:

Name of Contact of Payer Company: Jason Hill

Name of Payer Company: Chick-fil-a Address: 5200 Buffington Rd. Atlanta, GA 30349

Phone #: 404-684-8530 Mobile #: \_\_\_\_\_ Email: jhill@cfa.com

Electrical Contractor\*: Modern Signs, Inc.

Address: 1727 Armitage Ct. Addison, IL 60101 License #: E94792

Phone #: 630-495-1725 Mobile #: \_\_\_\_\_ Email: ernie@modernsignsinc.com

Website: \_\_\_\_\_

General Contractor\*: Modern Signs, Inc.

License #: TGC101520

Address: 1727 Armitage Ct. Addison, IL 60101

Phone #: 630-495-1725 Mobile #: \_\_\_\_\_ Email: ernie@modernsignsinc.com

Website: \_\_\_\_\_

\* if applicable.

Picture or rendering must be attached depicting sign placement with before and after view. Section 2 continues on next page

# CITY OF CHICAGO SIGN PERMIT APPLICATION CONTINUED

Expediter: \_\_\_\_\_  
Address: \_\_\_\_\_ License #: \_\_\_\_\_  
Phone #: \_\_\_\_\_ Mobile #: \_\_\_\_\_ Email: \_\_\_\_\_  
Website: \_\_\_\_\_

## Section 3 - Sign and Structure Details

(Please check all that apply)

### Sign Category:

On-Premise (Business ID): ☐ Dynamic ☒ Static  
Business License # of Tenant Business: Applied for Account # 412351  
Off-Premise (Advertising): ☐ Dynamic ☐ Static  
Temporary: ☐ Special Event: ☐

Sign will read (Please provide a description, picture and shop drawing): CFA logo

### Type of sign (Mark all that apply):

☐ Awning ☐ Canopy ☒ Freestanding ☐ Marquee ☐ Projecting ☐ Dynamic Image Display  
☐ Wall ☐ Painted ☒ Cabinet/Frame ☐ Vinyl ☐ Projected image ☐ Flashing  
☐ High Rise Building ☐ Hotel/Hospitals ☐ Other buildings: \_\_\_\_\_

What is the dimension of the wall on which the sign will be installed? \_\_\_\_\_

Where is sign or sign structure mounted? ☐ Inside the building ☒ Outside the building

Is the sign or sign structure attached to a building or wall?: ☐ Yes ☒ No If yes, which wall of building? N E S W

Is this a freestanding sign? ☒ Yes ☐ No Location of sign on lot: N E S W

Which direction does sign copy face? N E S W

Does any portion of the sign, sign structure or attachments cover, obscure or obstruct an existing window in a residential unit whether occupied or not? ☐ Yes ☒ No

Does any portion of the sign, sign structure, or attachments extend on or over the public way? ☐ Yes ☒ No

If yes, what is the public way use permit number? \_\_\_\_\_

Sign Panels: Back to back within 30 degrees of parallel ☒ Yes ☐ No

Number of Faces: 2

Sign Support Structure: ☒ Pole ☐ Roof ☐ Ground ☐ Building ☐ Windows ☐ Other: \_\_\_\_\_

Does any portion of the sign or sign structure extend 24 inches above the roof line as defined in 17-17-02149 of the Municipal Code of Chicago? ☐ Yes ☒ No

**Picture or rendering must be attached depicting sign placement with before and after view.**

Section 3 continues on next page

# CITY OF CHICAGO SIGN PERMIT APPLICATION CONTINUED

## Section 3 continued

### Dimensions of Sign Structure (i.e. cabinet, frame, awning, canopy)

Length: 11 Feet        Inches Height: 11 Feet        Inches Depth: 2 Feet        Inches

Area: 121 Sq. Ft. Weight: 300 lbs.

Shape of Sign: regular

### Sign Height above Grade:

From Grade to Bottom of sign or sign structure, whichever is lowest: 14' Ft.

From Grade to Top of sign or sign structure, whichever is highest: 25' Ft.

Is City Council Order required? \* ☒ Yes ☐ No

\*All signs in excess of 100 Square Feet in area OR in excess of 24 feet above grade require a City Council Order pursuant to Section 13-20-680 of the Municipal Code of Chicago

### Dimension of Sign Elements pursuant to Section 17-12-0601 of the Chicago Zoning Ordinance:

Length:        Feet        Inches Height:        Feet        inches Area:        Sq Ft.

Electrical Contractor will install: Feeders: ☐ Yes ☒ No Customer Leads: ☒ Yes ☐ No

Number of Lamps: 12 Total Wattage: 100 Type of Lamp: flourescent

Number of Ballast/Transformers: 1 Input of Transformers: 120

Type of Switch: special Location of Switch: listed flush toggle

Static: ☒ Yes ☐ No

Illuminated: ☒ Yes ☐ No

If yes - External        Internal ☒       

Dynamic Image Display: ☐ Yes ☒ No

(An affidavit of compliance is required for all dynamic image display signs pursuant to Section 13-20-675(d)(2) of the Municipal Code of Chicago.)

Max Nits        Max Foot Candles        Message Time (Screen Hold):        seconds

Self Dimming Capability: ☐ Yes ☐ No

What is the total of the sign face area devoted to dynamic image display?        Sq Ft.

## Section 4 - Zoning Information

Zoning District or Planned Development #: c3-3

Is sign located in a special sign district? ☐ Yes ☒ No

If yes: ☐ Michigan Ave. Corridor ☐ Oak St. Corridor ☐ State St./Wabash Ave. Corridor ☐ Chicago River Corridor

Total Street frontage of Zoning Lot: 288 + 320 = 608 (Ft.)

Total Area of new sign: 121 (Sq Ft.) Gross Area of all proposed signs: 570 (Sq Ft.)

Total Area of all existing signs on Zoning Lot: 0 (Sq Ft.)

Picture or rendering must be attached depicting sign placement with before and after view.

Section 4 continues on next page

# CITY OF CHICAGO SIGN PERMIT APPLICATION CONTINUED

## Section 4 continued

Distance from outer edge of sign or structure to curb line: 20 (Ft.)

Distance from inner edge of sign or sign structure to curb line: 31 (Ft.)

Distance from:

Public Park 10 acres or more: \_\_\_\_\_ (Ft.)

Public Park 2 acres or more: 500 (Ft.)

Expressway or Toll Road: 1000 (Ft.)

Lake Shore Drive: \_\_\_\_\_ (Ft.)

Michigan Avenue (Oak St. to Roosevelt Rd.): \_\_\_\_\_ (Ft.)

Residential District: 50 (Ft.)

Residential building in a D district: \_\_\_\_\_ (Ft.)

Existing off-premise/advertising signs on same side of street? ☐ Yes ☐ No

In a B or C District: \_\_\_\_\_ (Ft.)

In a D or M District: \_\_\_\_\_ (Ft.)

Waterways: \_\_\_\_\_ (Ft.)

## Section 5 - Sign Permit History

Does the proposed sign, change, alter or replace an existing sign? ☐ Yes ☒ No

If yes, were permits issued for the sign being replaced, changed or altered? ☐ Yes ☐ No

If yes, please list each permit number and date each permit was issued:

Permit Number: \_\_\_\_\_ Date issued: \_\_\_\_\_

Permit Number: \_\_\_\_\_ Date issued: \_\_\_\_\_

Permit Number: \_\_\_\_\_ Date issued: \_\_\_\_\_

Permit Number: \_\_\_\_\_ Date issued: \_\_\_\_\_

Does the proposed sign change a static sign to a dynamic image display sign? ☐ Yes ☐ No

Does the proposed sign change or alter the square footage or the height of the sign or sign structure? ☐ Yes ☐ No

Does the proposed sign change an on-premise sign to an off-premise/advertising sign? ☐ Yes ☐ No

## Section 6 - Attestation and Signatures

We, the undersigned, under penalty of perjury, do hereby affirm and attest that the above information is true, complete, and correct and acknowledge that incorrect information is grounds to revoke or rescind a permit.

Owner of Real Property: John Bodman Date 04/15/2019

Lessee of Real Property: Jason Hill Date 04/15/2019

Expediter: \_\_\_\_\_ Date \_\_\_\_\_

Supervising Electrician\*: William Leahy Date 04/15/2019

General Contractor\*: William Leahy Date 04/15/2019

\* if applicable.

Picture or rendering must be attached depicting sign placement with before and after view.

# CITY OF CHICAGO SIGN PERMIT APPLICATION CONTINUED

For Office Use

| ZONING | PUBLIC WAY |
|--------|------------|
|        |            |

**Sign Review Fee:**

Zoning Review Fee: \$ \_\_\_\_\_ Total Fee: \$ \_\_\_\_\_

Amount Paid: \$ \_\_\_\_\_ Balance Due: \$ \_\_\_\_\_

**PERMIT IS VALID FOR A PERIOD OF FIVE YEARS AFTER ISSUANCE. IT IS SOLELY  
THE RESPONSIBILITY OF THE OWNER OR LESSEE TO FILE FOR RENEWAL**

\* Once zoning fee is paid, this application is valid for a period of up to six months from payment date.

Applies to sign permits applied for on or after April 2, 2014.

City of Chicago  
Mayor Rahm Emanuel



Department of Buildings  
Judy Frydland, Commissioner

| Item             | Description              | Qty | Sign Area         | Allowed    |
|------------------|--------------------------|-----|-------------------|------------|
| A1               | Main ID Sign             | 1   | 150.00            | BELOW      |
| A2               | Main ID Sign             | 1   | <del>150.00</del> | BELOW 12.1 |
| B                | Wall Sign - Script S set | 1   | 58.75             | 602.25     |
| C                | Wall Sign - Script S set | 1   | 58.75             | 480.81     |
| D                | Wall Sign - Script S set | 1   | 58.75             | 480.81     |
| E                | Wall Sign - Script S set | 1   | 58.75             | 602.25     |
| Aggregate Totals |                          |     | 535.00            | 1153.32    |

| Item | Description                          | Qty |
|------|--------------------------------------|-----|
| K1   | DOT - Handicapped Parking            | 2   |
| K2   | DOT - Handicapped Parking (Van)      | 1   |
| L    | DOT - Pedestrian Sign                | 4   |
| M    | DOT - Stop                           | 2   |
| N    | DOT - Stop / Do Not Enter            | 2   |
| P1   | DOT - Catering & Carry Out           | 1   |
| H1   | Menu Board (Lane 1)                  | 1   |
| H2   | Menu Board (Lane 2)                  | 1   |
| CB   | Clearance Bar                        | 1   |
| FP   | Flag pole (50') freight not included | 1   |

P2 - RECOMMENDED FUTURE SITE FOR CURBSIDE DELIVERY SIGN PLACING  
(PERMIT FOR OFF-AN (VIRBIA) TO BE DETERMINED)

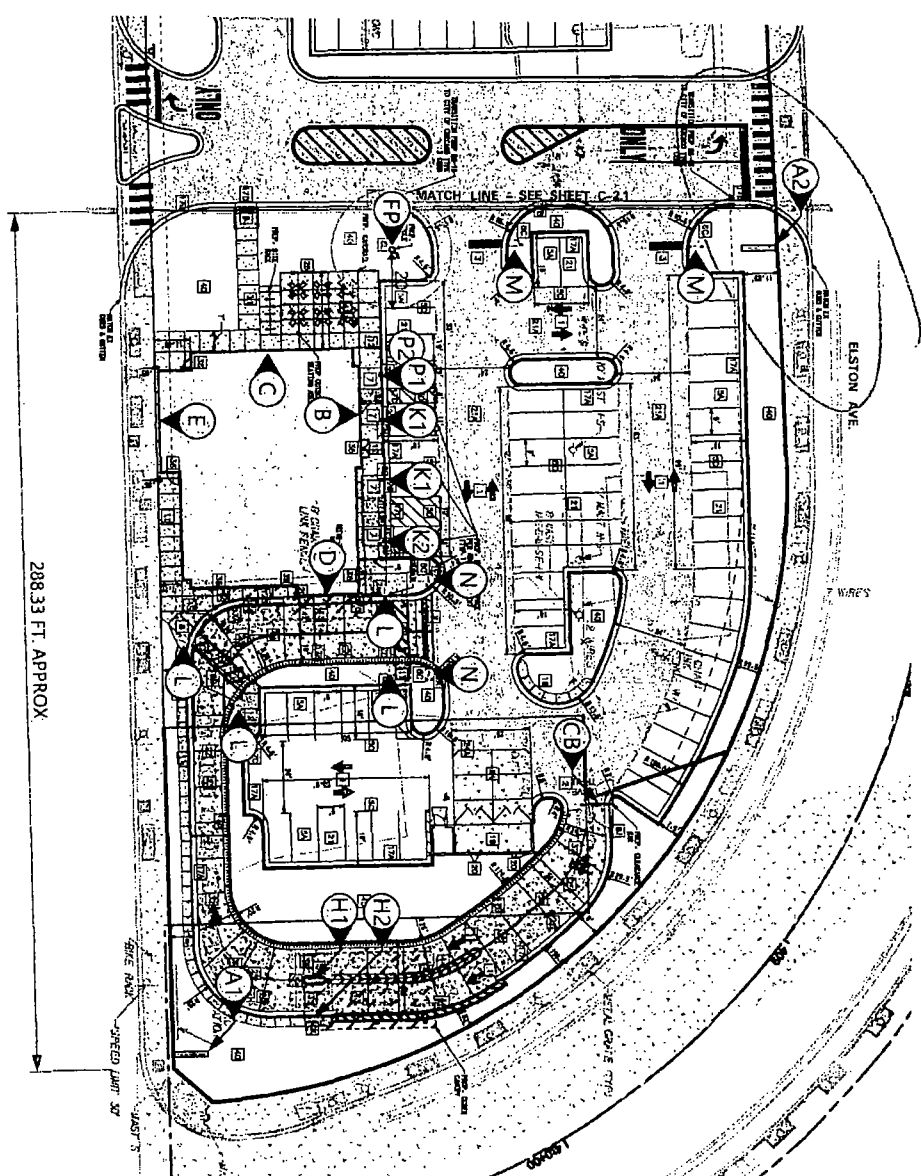

5198 North Lake Drive  
Lake City, GA 30260  
404.361.3800  
www.claytonsigns.com

# SITE PLAN

DRAWING FILE: C:\CHICKAGO\IN\DRAWING\STORAGE\COM

ALL ELECTRICAL  
UNLESS  
OTHERWISE INDICATED  
DRAWN BY: Ben Holliday  
ACCOUNT REP: Ben Holliday  
DRAWING DATE: February 6, 2019  
REVISION DATE:

STORE NUMBER: L03677  
STORE ADDRESS: CHICK-HA-BE CHICKAGO, IL (IN DARTON)  
N DARTON AVENUE  
CHICKAGO, IL 60647

THIS DRAWING IS AN ORIGINAL UNPUBLISHED DESIGN CREATED  
BY CLAYTON SIGNS, INC. ANY REPRODUCTION  
OR CHANGING OF ANY PART OF THIS DRAWING WITHOUT WRITTEN PERMISSION  
FROM CLAYTON SIGNS, INC. IS PROHIBITED.  
© 2019 ALL RIGHTS RESERVED



SEE ENGINEER STAMPED DRAWING  
FOR FOUNDATION DETAILS

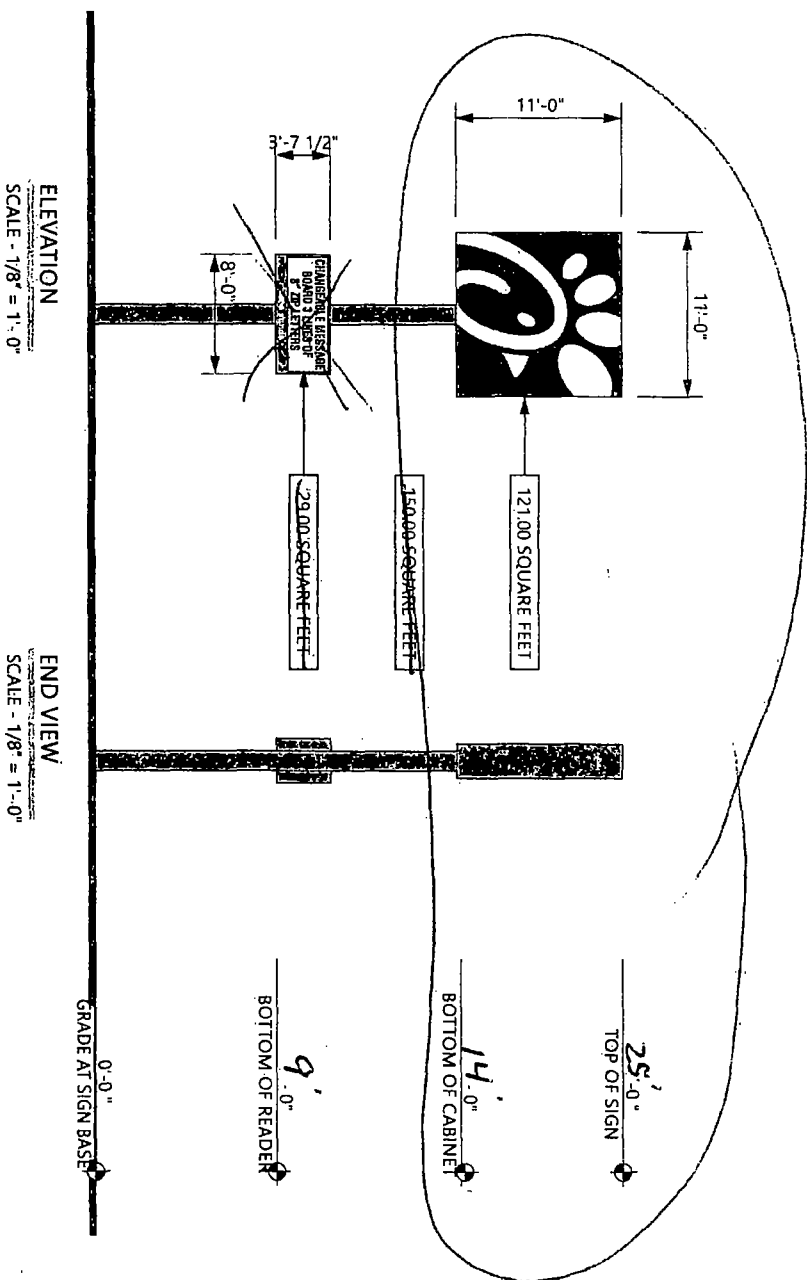
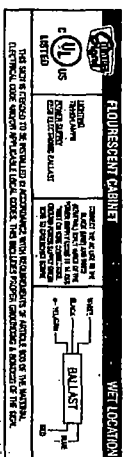

**CLAYTON**  
*Signs*  
50 YEARS

5198 North Lake Drive  
Lake City, GA 30260  
404.361.3800  
[www.daytonsigns.com](http://www.daytonsigns.com)

## DOUBLE-FACED PYLON SIGN

DRAWING FILE - CFA - CHICAGO, IL (N), DANKEN SIGNAGE.CDR

ALL ELECTRICAL  
SIGNS ARE  
120 VOLTS  
UNLESS  
OTHERWISE INDICATED

ACCOUNT REP Ben Holliday  
DRAWING DATE February 6, 2019  
REVISION DATE

**L03677**

Cluck-fli-A at Chicago 4. (N Damer)  
N. Damen Avenue  
Chicago IL 60647

THIS DRAWING IS AN ORIGINAL UNPUBLISHED DESIGN CREATED BY CANTON SIGNS, INC. IT IS NOT TO BE REPRODUCED, CHANGED OR EXEMPTED TO ANYONE OUTSIDE OF YOUR COMPANY IN WHOLE OR IN PART WITHOUT WRITTEN PERMISSION FROM THE OWNER OF CANTON SIGNS, INC. ANY SUCH ACTION(S) MAY BE SUBJECT TO LEGAL ACTION IN A COURT OF LAW

©2019 ALL RIGHTS RESERVED

LOCATION: A1/A2

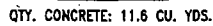

|  |            |                         |           |
|--|------------|-------------------------|-----------|
| A  | 01 Mar 19  | RELEASED FOR PERMITTING | J. HOGAN  |
| REV  | DATE       | DESCRIPTION             | APPROVED  |
| <p><b>Robert-James &amp; Associates, Inc.</b><br/>         12255 West 187th Street, Mokena Illinois 60448-9737<br/>         phone: 708-479-8385 fax: 708-479-8395 email: rja37@comcast.net</p> |            |                         |           |
| <p>TITLE<br/> <b>35'-0" OAH DIRECT BURY SINGLE POLE<br/>         FOR CHICK-FIL-A ID &amp; READERBOARD SIGNS</b></p>  |            |                         |           |
| DRAWN BY   | A. KLOTZKE | DATE                    | 01 Mar 19 |
| CHECKED BY   | J. HOGAN   | DATE                    | 01 Mar 19 |
| SCALE  |            | NONE                    |           |
| DRAWING NUMBER   |            | 1902151                 |           |
| SHEET  |            | 1 OF 1                  |           |
| REV.   |            | A                       |           |

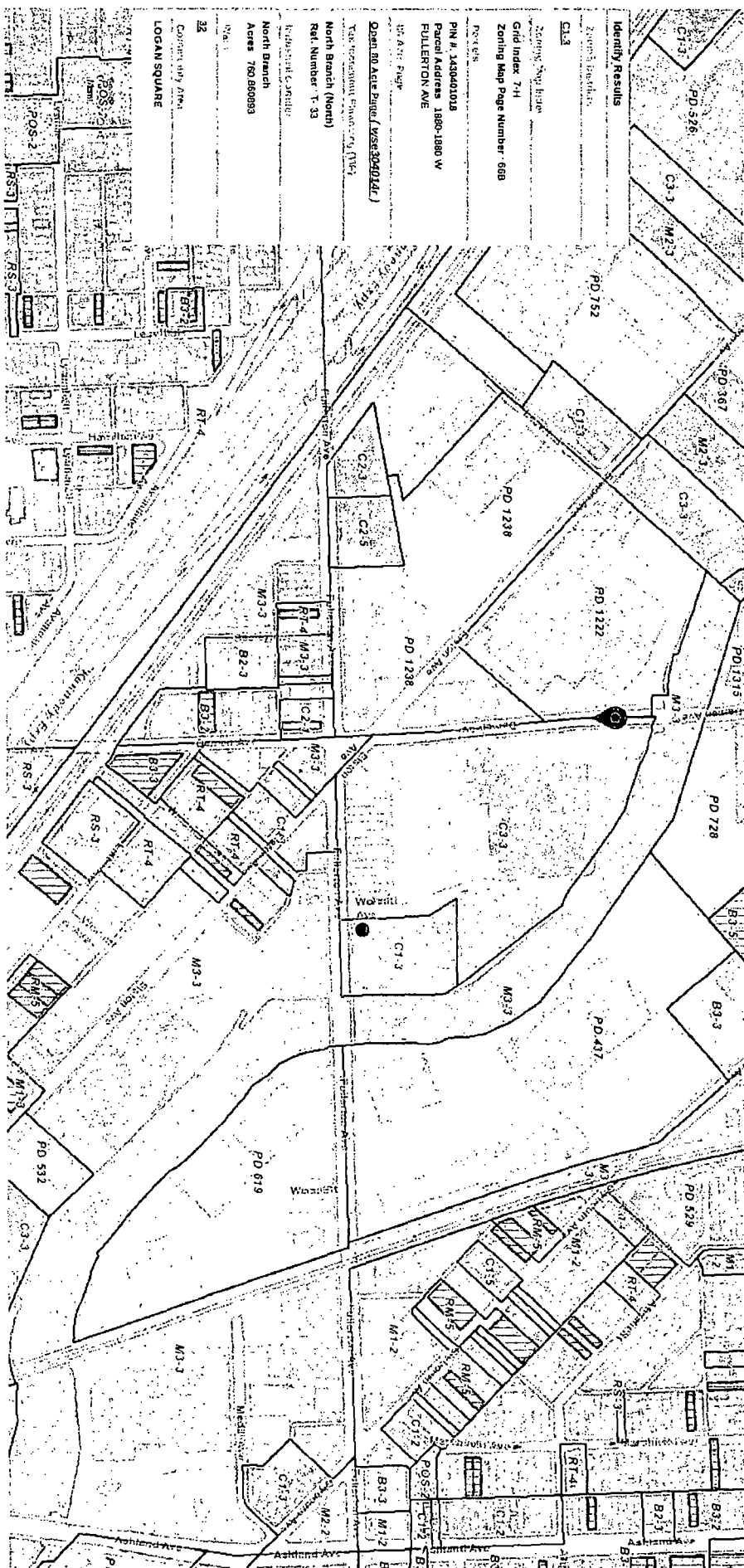

[illegible]