



# City of Chicago



O2020-4538

Office of the City Clerk

## Document Tracking Sheet

<b>Meeting Date:</b>	9/9/2020
<b>Sponsor(s):</b>	Misc. Transmittal
<b>Type:</b>	Ordinance
<b>Title:</b>	Zoning Reclassification Map No. 9-F at 3343 N Halsted St - 20514T1
<b>Committee(s) Assignment:</b>	Committee on Zoning, Landmarks and Building Standards

Final for Publication  
**ORDINANCE**

***BE IT ORDAINED BY THE CITY COUNCIL OF THE CITY OF CHICAGO:***

***SECTION 1.*** Title 17 of the Municipal Code, the Chicago Zoning Ordinance,  
be amended by changing all the C1-2 Neighborhood Commercial District  
symbols and indications as shown on Map No. 9-F in the area bounded by  
a line 93.68 feet north of and parallel to West Buckingham Place; the  
Alley next east of and parallel to North Halsted Street; a line 66.68 feet  
north of and parallel to West Buckingham Place; and North Halsted Street;  
to those of a C1-3 Neighborhood Commercial District is hereby established in the  
area above described.

***SECTION 2.*** This ordinance shall be in force and effect from and after its passage and  
due publication.

Common Address of Property:      3343 N. Halsted Street

ZONING NARRATIVE FOR 3343 N. HASTED STREET, CHICAGO, IL 60657

TYPE 1 NARRATIVE AND PLANS

Use:	The subject property is improved with a partially built, 4-story mixed use building. Originally, the FAR for the proposed building was around 6,468 sq. ft. pursuant to permit #100844364. The Applicant/Owner would like to amend the plans and add around of 470 sq. ft. to the first floor of the building, which will contain commercial/retail space and a vestibule for the dwelling units. Around 380 sq. ft. will be added to the commercial/retail space, while 90 sq. ft. will be added to the vestibule. When complete, the proposed mixed use building will contain around 6,938 sq. ft.
Project's Floor Area:	2.36
Project's Density:	2 Dwelling Units, 1,470.5 sq. ft.
Parking:	Two (2) parking spaces. New attached 2-car garage.
Setbacks:	Front: 0' Rear: 30'-0" Side Setbacks: <ul style="list-style-type: none"><li>▪ North Side Setback: 0'</li><li>▪ South Side Setback: 0'</li></ul>
Building Height:	45'-10"

# Final Publication

## EXISTING 4 STORY 2 DWELLING UNIT BUILDING W/ ROOF DECKS AND 2 CAR GARAGE W/ NEW GROUND FLOOR BUSINESS USE AND EXPANSION OF ALLOWABLE SQFT ON GROUND FLOOR 3343 NORTH HALSTED STREET CHICAGO, IL

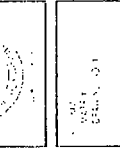
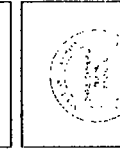
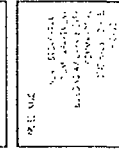
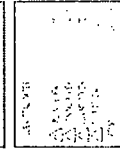
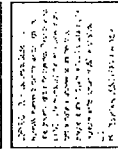
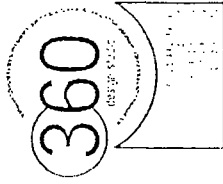

<p><b>APPLICABLE CODES</b></p> <p>2015 IBC 2015 IRC 2015 IFC 2015 ILCS 2015 CMR 2015 CCR 2015 CFC 2015 CFCR 2015 CFCR</p>	<p><b>LIMITATION OF WARRANTY OF ARCHITECT'S WORK PRODUCT</b></p> <p>THE ARCHITECT'S WORK PRODUCT IS PROVIDED AS IS, WITHOUT WARRANTY OF ANY KIND, EXPRESS OR IMPLIED, INCLUDING BUT NOT LIMITED TO THE WARRANTIES OF MERCHANTABILITY, FITNESS FOR A PARTICULAR PURPOSE AND NONINFRINGEMENT. THE ARCHITECT DOES NOT WARRANT THAT THE WORK PRODUCT IS FREE OF ERRORS OR OMISSIONS, OR THAT THE WORK PRODUCT WILL MEET THE REQUIREMENTS OF ANY PARTICULAR JURISDICTION. THE ARCHITECT'S WORK PRODUCT IS NOT TO BE USED FOR ANY PURPOSE OTHER THAN THAT FOR WHICH IT WAS DESIGNED.</p>	<p><b>ARCHITECT'S STATEMENT &amp; SEAL</b></p> <p>STATE OF ILLINOIS COUNTY OF COOK I, [Signature], Architect, do hereby certify that I am the author of the foregoing work product, and that I am a duly licensed architect in the State of Illinois.</p>
---	--	---

NO.	DESCRIPTION	DATE	BY	REVISION
1	1.00	1/1/15	1/1/15	1/1/15
2	2.00	2/1/15	2/1/15	2/1/15
3	3.00	3/1/15	3/1/15	3/1/15
4	4.00	4/1/15	4/1/15	4/1/15
5	5.00	5/1/15	5/1/15	5/1/15
6	6.00	6/1/15	6/1/15	6/1/15
7	7.00	7/1/15	7/1/15	7/1/15
8	8.00	8/1/15	8/1/15	8/1/15
9	9.00	9/1/15	9/1/15	9/1/15
10	10.00	10/1/15	10/1/15	10/1/15
11	11.00	11/1/15	11/1/15	11/1/15
12	12.00	12/1/15	12/1/15	12/1/15
13	13.00	1/1/16	1/1/16	1/1/16
14	14.00	2/1/16	2/1/16	2/1/16
15	15.00	3/1/16	3/1/16	3/1/16
16	16.00	4/1/16	4/1/16	4/1/16
17	17.00	5/1/16	5/1/16	5/1/16
18	18.00	6/1/16	6/1/16	6/1/16
19	19.00	7/1/16	7/1/16	7/1/16
20	20.00	8/1/16	8/1/16	8/1/16
21	21.00	9/1/16	9/1/16	9/1/16
22	22.00	10/1/16	10/1/16	10/1/16
23	23.00	11/1/16	11/1/16	11/1/16
24	24.00	12/1/16	12/1/16	12/1/16
25	25.00	1/1/17	1/1/17	1/1/17
26	26.00	2/1/17	2/1/17	2/1/17
27	27.00	3/1/17	3/1/17	3/1/17
28	28.00	4/1/17	4/1/17	4/1/17
29	29.00	5/1/17	5/1/17	5/1/17
30	30.00	6/1/17	6/1/17	6/1/17
31	31.00	7/1/17	7/1/17	7/1/17
32	32.00	8/1/17	8/1/17	8/1/17
33	33.00	9/1/17	9/1/17	9/1/17
34	34.00	10/1/17	10/1/17	10/1/17
35	35.00	11/1/17	11/1/17	11/1/17
36	36.00	12/1/17	12/1/17	12/1/17
37	37.00	1/1/18	1/1/18	1/1/18
38	38.00	2/1/18	2/1/18	2/1/18
39	39.00	3/1/18	3/1/18	3/1/18
40	40.00	4/1/18	4/1/18	4/1/18
41	41.00	5/1/18	5/1/18	5/1/18
42	42.00	6/1/18	6/1/18	6/1/18
43	43.00	7/1/18	7/1/18	7/1/18
44	44.00	8/1/18	8/1/18	8/1/18
45	45.00	9/1/18	9/1/18	9/1/18
46	46.00	10/1/18	10/1/18	10/1/18
47	47.00	11/1/18	11/1/18	11/1/18
48	48.00	12/1/18	12/1/18	12/1/18
49	49.00	1/1/19	1/1/19	1/1/19
50	50.00	2/1/19	2/1/19	2/1/19
51	51.00	3/1/19	3/1/19	3/1/19
52	52.00	4/1/19	4/1/19	4/1/19
53	53.00	5/1/19	5/1/19	5/1/19
54	54.00	6/1/19	6/1/19	6/1/19
55	55.00	7/1/19	7/1/19	7/1/19
56	56.00	8/1/19	8/1/19	8/1/19
57	57.00	9/1/19	9/1/19	9/1/19
58	58.00	10/1/19	10/1/19	10/1/19
59	59.00	11/1/19	11/1/19	11/1/19
60	60.00	12/1/19	12/1/19	12/1/19
61	61.00	1/1/20	1/1/20	1/1/20
62	62.00	2/1/20	2/1/20	2/1/20
63	63.00	3/1/20	3/1/20	3/1/20
64	64.00	4/1/20	4/1/20	4/1/20
65	65.00	5/1/20	5/1/20	5/1/20
66	66.00	6/1/20	6/1/20	6/1/20
67	67.00	7/1/20	7/1/20	7/1/20
68	68.00	8/1/20	8/1/20	8/1/20
69	69.00	9/1/20	9/1/20	9/1/20
70	70.00	10/1/20	10/1/20	10/1/20
71	71.00	11/1/20	11/1/20	11/1/20
72	72.00	12/1/20	12/1/20	12/1/20
73	73.00	1/1/21	1/1/21	1/1/21
74	74.00	2/1/21	2/1/21	2/1/21
75	75.00	3/1/21	3/1/21	3/1/21
76	76.00	4/1/21	4/1/21	4/1/21
77	77.00	5/1/21	5/1/21	5/1/21
78	78.00	6/1/21	6/1/21	6/1/21
79	79.00	7/1/21	7/1/21	7/1/21
80	80.00	8/1/21	8/1/21	8/1/21
81	81.00	9/1/21	9/1/21	9/1/21
82	82.00	10/1/21	10/1/21	10/1/21
83	83.00	11/1/21	11/1/21	11/1/21
84	84.00	12/1/21	12/1/21	12/1/21
85	85.00	1/1/22	1/1/22	1/1/22
86	86.00	2/1/22	2/1/22	2/1/22
87	87.00	3/1/22	3/1/22	3/1/22
88	88.00	4/1/22	4/1/22	4/1/22
89	89.00	5/1/22	5/1/22	5/1/22
90	90.00	6/1/22	6/1/22	6/1/22
91	91.00	7/1/22	7/1/22	7/1/22
92	92.00	8/1/22	8/1/22	8/1/22
93	93.00	9/1/22	9/1/22	9/1/22
94	94.00	10/1/22	10/1/22	10/1/22
95	95.00	11/1/22	11/1/22	11/1/22
96	96.00	12/1/22	12/1/22	12/1/22
97	97.00	1/1/23	1/1/23	1/1/23
98	98.00	2/1/23	2/1/23	2/1/23
99	99.00	3/1/23	3/1/23	3/1/23
100	100.00	4/1/23	4/1/23	4/1/23

NO.	DESCRIPTION	DATE	BY	REVISION
1	1.00	1/1/15	1/1/15	1/1/15
2	2.00	2/1/15	2/1/15	2/1/15
3	3.00	3/1/15	3/1/15	3/1/15
4	4.00	4/1/15	4/1/15	4/1/15
5	5.00	5/1/15	5/1/15	5/1/15
6	6.00	6/1/15	6/1/15	6/1/15
7	7.00	7/1/15	7/1/15	7/1/15
8	8.00	8/1/15	8/1/15	8/1/15
9	9.00	9/1/15	9/1/15	9/1/15
10	10.00	10/1/15	10/1/15	10/1/15
11	11.00	11/1/15	11/1/15	11/1/15
12	12.00	12/1/15	12/1/15	12/1/15
13	13.00	1/1/16	1/1/16	1/1/16
14	14.00	2/1/16	2/1/16	2/1/16
15	15.00	3/1/16	3/1/16	3/1/16
16	16.00	4/1/16	4/1/16	4/1/16
17	17.00	5/1/16	5/1/16	5/1/16
18	18.00	6/1/16	6/1/16	6/1/16
19	19.00	7/1/16	7/1/16	7/1/16
20	20.00	8/1/16	8/1/16	8/1/16
21	21.00	9/1/16	9/1/16	9/1/16
22	22.00	10/1/16	10/1/16	10/1/16
23	23.00	11/1/16	11/1/16	11/1/16
24	24.00	12/1/16	12/1/16	12/1/16
25	25.00	1/1/17	1/1/17	1/1/17
26	26.00	2/1/17	2/1/17	2/1/17
27	27.00	3/1/17	3/1/17	3/1/17
28	28.00	4/1/17	4/1/17	4/1/17
29	29.00	5/1/17	5/1/17	5/1/17
30	30.00	6/1/17	6/1/17	6/1/17
31	31.00	7/1/17	7/1/17	7/1/17
32	32.00	8/1/17	8/1/17	8/1/17
33	33.00	9/1/17	9/1/17	9/1/17
34	34.00	10/1/17	10/1/17	10/1/17
35	35.00	11/1/17	11/1/17	11/1/17
36	36.00	12/1/17	12/1/17	12/1/17
37	37.00	1/1/18	1/1/18	1/1/18
38	38.00	2/1/18	2/1/18	2/1/18
39	39.00	3/1/18	3/1/18	3/1/18
40	40.00	4/1/18	4/1/18	4/1/18
41	41.00	5/1/18	5/1/18	5/1/18
42	42.00	6/1/18	6/1/18	6/1/18
43	43.00	7/1/18	7/1/18	7/1/18
44	44.00	8/1/18	8/1/18	8/1/18
45	45.00	9/1/18	9/1/18	9/1/18
46	46.00	10/1/18	10/1/18	10/1/18
47	47.00	11/1/18	11/1/18	11/1/18
48	48.00	12/1/18	12/1/18	12/1/18
49	49.00	1/1/19	1/1/19	1/1/19
50	50.00	2/1/19	2/1/19	2/1/19
51	51.00	3/1/19	3/1/19	3/1/19
52	52.00	4/1/19	4/1/19	4/1/19
53	53.00	5/1/19	5/1/19	5/1/19
54	54.00	6/1/19	6/1/19	6/1/19
55	55.00	7/1/19	7/1/19	7/1/19
56	56.00	8/1/19	8/1/19	8/1/19
57	57.00	9/1/19	9/1/19	9/1/19
58	58.00	10/1/19	10/1/19	10/1/19
59	59.00	11/1/19	11/1/19	11/1/19
60	60.00	12/1/19	12/1/19	12/1/19
61	61.00	1/1/20	1/1/20	1/1/20
62	62.00	2/1/20	2/1/20	2/1/20
63	63.00	3/1/20	3/1/20	3/1/20
64	64.00	4/1/20	4/1/20	4/1/20
65	65.00	5/1/20	5/1/20	5/1/20
66	66.00	6/1/20	6/1/20	6/1/20
67	67.00	7/1/20	7/1/20	7/1/20
68	68.00	8/1/20	8/1/20	8/1/20
69	69.00	9/1/20	9/1/20	9/1/20
70	70.00	10/1/20	10/1/20	10/1/20
71	71.00	11/1/20	11/1/20	11/1/20
72	72.00	12/1/20	12/1/20	12/1/20
73	73.00	1/1/21	1/1/21	1/1/21
74	74.00	2/1/21	2/1/21	2/1/21
75	75.00	3/1/21	3/1/21	3/1/21
76	76.00	4/1/21	4/1/21	4/1/21
77	77.00	5/1/21	5/1/21	5/1/21
78	78.00	6/1/21	6/1/21	6/1/21
79	79.00	7/1/21	7/1/21	7/1/21
80	80.00	8/1/21	8/1/21	8/1/21
81	81.00	9/1/21	9/1/21	9/1/21
82	82.00	10/1/21	10/1/21	10/1/21
83	83.00	11/1/21	11/1/21	11/1/21
84	84.00	12/1/21	12/1/21	12/1/21
85	85.00	1/1/22	1/1/22	1/1/22
86	86.00	2/1/22	2/1/22	2/1/22
87	87.00	3/1/22	3/1/22	3/1/22
88	88.00	4/1/22	4/1/22	4/1/22
89	89.00	5/1/22	5/1/22	5/1/22
90	90.00	6/1/22	6/1/22	6/1/22
91	91.00	7/1/22	7/1/22	7/1/22
92	92.00	8/1/22	8/1/22	8/1/22
93	93.00	9/1/22	9/1/22	9/1/22
94	94.00	10/1/22	10/1/22	10/1/22
95	95.00	11/1/22	11/1/22	11/1/22
96	96.00	12/1/22	12/1/22	12/1/22
97	97.00	1/1/23	1/1/23	1/1/23
98	98.00	2/1/23	2/1/23	2/1/23
99	99.00	3/1/23	3/1/23	3/1/23
100	100.00	4/1/23	4/1/23	4/1/23

[illegible]

GENERAL NOTES

GENERAL NOTES

GENERAL NOTES

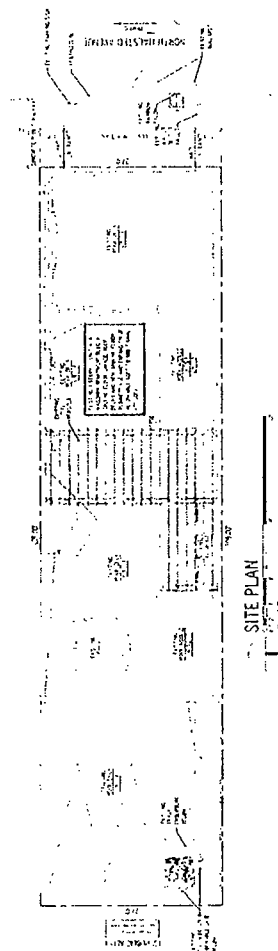

100

WALL END		SUBSTANCES		WALL END
1-2	3-4	5-6	7-8	9-10
<input type="checkbox"/>				
<input type="checkbox"/>				
<input type="checkbox"/>				

10

Floor plan of the first floor of the 'HOTEL' building. The plan shows a large central hall with a circular feature in the center. To the left of the hall is a kitchen area with a stove and sink. To the right of the hall are several smaller rooms, including a bathroom and a bedroom. A north arrow is located in the upper right corner. Numbered locations 1 through 10 are marked throughout the plan.

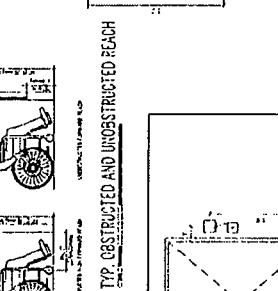

2000 2001 2002 2003 2004 2005 2006 2007 2008 2009 2010 2011 2012 2013 2014 2015 2016 2017 2018 2019 2020 2021 2022 2023 2024 2025 2026 2027 2028 2029 2030 2031 2032 2033 2034 2035 2036 2037 2038 2039 2040 2041 2042 2043 2044 2045 2046 2047 2048 2049 2050 2051 2052 2053 2054 2055 2056 2057 2058 2059 2060 2061 2062 2063 2064 2065 2066 2067 2068 2069 2070 2071 2072 2073 2074 2075 2076 2077 2078 2079 2080 2081 2082 2083 2084 2085 2086 2087 2088 2089 2090 2091 2092 2093 2094 2095 2096 2097 2098 2099 2100 2101 2102 2103 2104 2105 2106 2107 2108 2109 2110 2111 2112 2113 2114 2115 2116 2117 2118 2119 2120 2121 2122 2123 2124 2125 2126 2127 2128 2129 2130 2131 2132 2133 2134 2135 2136 2137 2138 2139 2140 2141 2142 2143 2144 2145 2146 2147 2148 2149 2150 2151 2152 2153 2154 2155 2156 2157 2158 2159 2160 2161 2162 2163 2164 2165 2166 2167 2168 2169 2170 2171 2172 2173 2174 2175 2176 2177 2178 2179 2180 2181 2182 2183 2184 2185 2186 2187 2188 2189 2190 2191 2192 2193 2194 2195 2196 2197 2198 2199 2200 2201 2202 2203 2204 2205 2206 2207 2208 2209 2210 2211 2212 2213 2214 2215 2216 2217 2218 2219 2220 2221 2222 2223 2224 2225 2226 2227 2228 2229 2230 2231 2232 2233 2234 2235 2236 2237 2238 2239 2240 2241 2242 2243 2244 2245 2246 2247 2248 2249 2250 2251 2252 2253 2254 2255 2256 2257 2258 2259 2260 2261 2262 2263 2264 2265 2266 2267 2268 2269 2270 2271 2272 2273 2274 2275 2276 2277 2278 2279 2280 2281 2282 2283 2284 2285 2286 2287 2288 2289 2290 2291 2292 2293 2294 2295 2296 2297 2298 2299 2300 2301 2302 2303 2304 2305 2306 2307 2308 2309 2310 2311 2312 2313 2314 2315 2316 2317 2318 2319 2320 2321 2322 2323 2324 2325 2326 2327 2328 2329 2330 2331 2332 2333 2334 2335 2336 2337 2338 2339 2340 2341 2342 2343 2344 2345 2346 2347 2348 2349 2350 2351 2352 2353 2354 2355 2356 2357 2358 2359 2360 2361 2362 2363 2364 2365 2366 2367 2368 2369 2370 2371 2372 2373 2374 2375 2376 2377 2378 2379 2380 2381 2382 2383 2384 2385 2386 2387 2388 2389 2390 2391 2392 2393 2394 2395 2396 2397 2398 2399 2400 2401 2402 2403 2404 2405 2406 2407 2408 2409 2410 2411 2412 2413 2414 2415 2416 2417 2418 2419 2420 2421 2422 2423 2424 2425 2426 2427 2428 2429 2430 2431 2432 2433 2434 2435 2436 2437 2438 2439 2440 2441 2442 2443 2444 2445 2446 2447 2448 2449 2450 2451 2452 2453 2454 2455 2456 2457 2458 2459 2460 2461 2462 2463 2464 2465 2466 2467 2468 2469 2470 2471 2472 2473 2474 2475 2476 2477 2478 2479 2480 2481 2482 2483 2484 2485 2486 2487 2488 2489 2490 2491 2492 2493 2494 2495 2496 2497 2498 2499 2500 2501 2502 2503 2504 2505 2506 2507 2508 2509 2510 2511 2512 2513 2514 2515 2516 2517 2518 2519 2520 2521 2522 2523 2524 2525 2526 2527 2528 2529 2530 2531 2532 2533 2534 2535 2536 2537 2538 2539 2540 2541 2542 2543 2544 2545 2546 2547 2548 2549 2550 2551 2552 2553 2554 2555 2556 2557 2558 2559 2560 2561 2562 2563 2564 2565 2566 2567 2568 2569 2570 2571 2572 2573 2574 2575 2576 2577 2578 2579 2580 2581 2582 2583 2584 2585 2586 2587 2588 2589 2590 2591 2592 2593 2594 2595 2596 2597 2598 2599 2600 2601 2602 2603 2604 2605 2606 2607 2608 2609 2610 2611 2612 2613 2614 2615 2616 2617 2618 2619 2620 2621 2622 2623 2624 2625 2626 2627 2628 2629 2630 2631 2632 2633 2634 2635 2636 2637 2638 2639 2640 2641 2642 2643 2644 2645 2646 2647 2648 2649 2650 2651 2652 2653 2654 2655 2656 2657 2658 2659 2660 2661 2662 2663 2664 2665 2666 2667 2668 2669 2670 2671 2672 2673 2674 2675 2676 2677 2678 2679 2680 2681 2682 2683 2684 2685 2686 2687 2688 2689 2690 2691 2692 2693 2694 2695 2696 2697 2698 2699 2700 2701 2702 2703 2704 2705 2706 2707 2708 2709 2710 2711 2712 2713 2714 2715 2716 2717 2718 2719 2720 2721 2722 2723 2724 2725 2726 2727 2728 2729 2730 2731 2732 2733 2734 2735 2736 2737 2738 2739 2740 2741 2742 2743 2744 2745 2746 2747 2748 2749 2750 2751 2752 2753 2754 2755 2756 2757 2758 2759 2760 2761 2762 2763 2764 2765 2766 2767 2768 2769 2770 2771 2772 2773 2774 2775 2776 2777 2778 2779 2780 2781 2782 2783 2784 2785 2786 2787 2788 2789 2790 2791 2792 2793 2794 2795 2796 2797 2798 2799 2800 2801 2802 2803 2804 2805 2806 2807 2808 2809 2810 2811 2812 2813 2814 2815 2816 2817 2818

100

	0	1	2	3	4	5	6	7	8	9	10	11	12	13	14	15	16	17	18	19	20	21	22	23	24	25	26	27	28	29	30	31	32	33	34	35	36	37	38	39	40	41	42	43	44	45	46	47	48	49	50	51	52	53	54	55	56	57	58	59	60	61	62	63	64	65	66	67	68	69	70	71	72	73	74	75	76	77	78	79	80	81	82	83	84	85	86	87	88	89	90	91	92	93	94	95	96	97	98	99	100	101	102	103	104	105	106	107	108	109	110	111	112	113	114	115	116	117	118	119	120	121	122	123	124	125	126	127	128	129	130	131	132	133	134	135	136	137	138	139	140	141	142	143	144	145	146	147	148	149	150	151	152	153	154	155	156	157	158	159	160	161	162	163	164	165	166	167	168	169	170	171	172	173	174	175	176	177	178	179	180	181	182	183	184	185	186	187	188	189	190	191	192	193	194	195	196	197	198	199	200	201	202	203	204	205	206	207	208	209	210	211	212	213	214	215	216	217	218	219	220	221	222	223	224	225	226	227	228	229	230	231	232	233	234	235	236	237	238	239	240	241	242	243	244	245	246	247	248	249	250	251	252	253	254	255	256	257	258	259	260	261	262	263	264	265	266	267	268	269	270	271	272	273	274	275	276	277	278	279	280	281	282	283	284	285	286	287	288	289	290	291	292	293	294	295	296	297	298	299	300	301	302	303	304	305	306	307	308	309	310	311	312	313	314	315	316	317	318	319	320	321	322	323	324	325	326	327	328	329	330	331	332	333	334	335	336	337	338	339	340	341	342	343	344	345	346	347	348	349	350	351	352	353	354	355	356	357	358	359	360	361	362	363	364	365	366	367	368	369	370	371	372	373	374	375	376	377	378	379	380	381	382	383	384	385	386	387	388	389	390	391	392	393	394	395	396	397	398	399	400	401	402	403	404	405	406	407	408	409	410	411	412	413	414	415	416	417	418	419	420	421	422	423	424	425	426	427	428	429	430	431	432	433	434	435	436	437	438	439	440	441	442	443	444	445	446	447	448	449	450	451	452	453	454	455	456	457	458	459	460	461	462	463	464	465	466	467	468	469	470	471	472	473	474	475	476	477	478	479	480	481	482	483	484	485	486	487	488	489	490	491	492	493	494	495	496	497	498	499	500	501	502	503	504	505	506	507	508	509	510	511	512	513	514	515	516	517	518	519	520	521	522	523
--	---	---	---	---	---	---	---	---	---	---	----	----	----	----	----	----	----	----	----	----	----	----	----	----	----	----	----	----	----	----	----	----	----	----	----	----	----	----	----	----	----	----	----	----	----	----	----	----	----	----	----	----	----	----	----	----	----	----	----	----	----	----	----	----	----	----	----	----	----	----	----	----	----	----	----	----	----	----	----	----	----	----	----	----	----	----	----	----	----	----	----	----	----	----	----	----	----	----	----	----	-----	-----	-----	-----	-----	-----	-----	-----	-----	-----	-----	-----	-----	-----	-----	-----	-----	-----	-----	-----	-----	-----	-----	-----	-----	-----	-----	-----	-----	-----	-----	-----	-----	-----	-----	-----	-----	-----	-----	-----	-----	-----	-----	-----	-----	-----	-----	-----	-----	-----	-----	-----	-----	-----	-----	-----	-----	-----	-----	-----	-----	-----	-----	-----	-----	-----	-----	-----	-----	-----	-----	-----	-----	-----	-----	-----	-----	-----	-----	-----	-----	-----	-----	-----	-----	-----	-----	-----	-----	-----	-----	-----	-----	-----	-----	-----	-----	-----	-----	-----	-----	-----	-----	-----	-----	-----	-----	-----	-----	-----	-----	-----	-----	-----	-----	-----	-----	-----	-----	-----	-----	-----	-----	-----	-----	-----	-----	-----	-----	-----	-----	-----	-----	-----	-----	-----	-----	-----	-----	-----	-----	-----	-----	-----	-----	-----	-----	-----	-----	-----	-----	-----	-----	-----	-----	-----	-----	-----	-----	-----	-----	-----	-----	-----	-----	-----	-----	-----	-----	-----	-----	-----	-----	-----	-----	-----	-----	-----	-----	-----	-----	-----	-----	-----	-----	-----	-----	-----	-----	-----	-----	-----	-----	-----	-----	-----	-----	-----	-----	-----	-----	-----	-----	-----	-----	-----	-----	-----	-----	-----	-----	-----	-----	-----	-----	-----	-----	-----	-----	-----	-----	-----	-----	-----	-----	-----	-----	-----	-----	-----	-----	-----	-----	-----	-----	-----	-----	-----	-----	-----	-----	-----	-----	-----	-----	-----	-----	-----	-----	-----	-----	-----	-----	-----	-----	-----	-----	-----	-----	-----	-----	-----	-----	-----	-----	-----	-----	-----	-----	-----	-----	-----	-----	-----	-----	-----	-----	-----	-----	-----	-----	-----	-----	-----	-----	-----	-----	-----	-----	-----	-----	-----	-----	-----	-----	-----	-----	-----	-----	-----	-----	-----	-----	-----	-----	-----	-----	-----	-----	-----	-----	-----	-----	-----	-----	-----	-----	-----	-----	-----	-----	-----	-----	-----	-----	-----	-----	-----	-----	-----	-----	-----	-----	-----	-----	-----	-----	-----	-----	-----	-----	-----	-----	-----	-----	-----	-----	-----	-----	-----	-----	-----	-----	-----	-----	-----	-----	-----	-----	-----	-----	-----	-----	-----	-----	-----	-----	-----	-----	-----	-----	-----	-----	-----	-----	-----	-----	-----	-----	-----	-----	-----	-----	-----	-----	-----	-----	-----	-----	-----	-----	-----	-----	-----	-----	-----	-----	-----	-----	-----	-----	-----	-----	-----	-----	-----	-----	-----	-----	-----	-----	-----	-----	-----	-----	-----	-----	-----	-----	-----	-----	-----	-----	-----

*[Faint handwritten notes and markings]*

# Final Publication

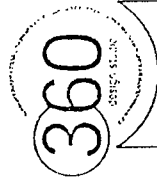

DESIGN STUDIO  
1000 10TH AVENUE  
SUITE 1000  
DENVER, CO 80202  
TEL: 303.733.1300  
WWW.DESIGNSTUDIO.CO

DESIGN STUDIO  
1000 10TH AVENUE  
SUITE 1000  
DENVER, CO 80202  
TEL: 303.733.1300  
WWW.DESIGNSTUDIO.CO

DESIGN STUDIO  
1000 10TH AVENUE  
SUITE 1000  
DENVER, CO 80202  
TEL: 303.733.1300  
WWW.DESIGNSTUDIO.CO

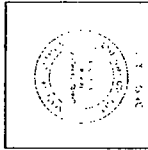

DESIGN STUDIO  
1000 10TH AVENUE  
SUITE 1000  
DENVER, CO 80202  
TEL: 303.733.1300  
WWW.DESIGNSTUDIO.CO

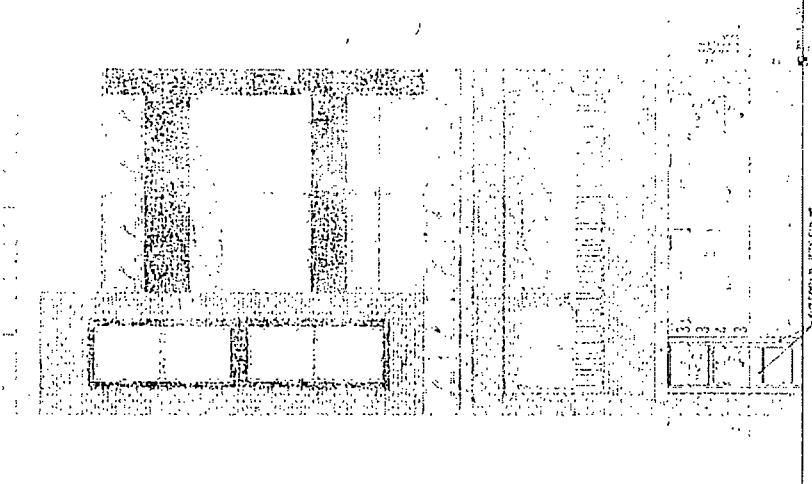

EXISTING WEST ELEVATION

TRANSFORMER CALCULATION	
TRANSFORMER	1000 KVA
TRANSFORMER	1000 KVA
TRANSFORMER	1000 KVA
TRANSFORMER	1000 KVA