



City of Chicago



Or2020-316

Office of the City Clerk

Document Tracking Sheet

Meeting Date:	11/16/2020
Sponsor(s):	Reilly (42)
Type:	Order
Title:	Issuance of permits for sign(s)/signboard(s) at 35 N State St
Committee(s) Assignment:	Committee on Zoning, Landmarks and Building Standards

CITY COUNCIL
COMMITTEE ON ZONING, LANDMARKS AND BUILDING STANDARDS

COUNCIL ORDER

RE: Approval of sign over 100 square feet in area or over 24 feet above grade

ORDERED, that the City Council hereby approves the following sign application submitted by:

Applicant*: PRIMARK

(* The Applicant is the owner of the real property or the business tenant of the real property. Do not list the sign contractor, sign erector, sign company or advertising entity in the above space.)

This Order approves the following sign in accordance with Municipal Code of Chicago Section 13-20-680:

Address of Sign: 35 N. STATE Chicago, IL 60602

Zoning District: DX-16

DOB Sign Permit Application #: 100896862

Sign Details:

1. On-premise OR Off-premise
2. Static sign OR Dynamic-image display sign
3. Number of sign faces 2
4. Projecting over the public way Y (Yes or No) If yes, Public Way Use #: 1147017
5. Dimensions: Length 2 feet 11.5 inches Height 19 feet 6 inches
Total square feet in area: 57 feet 0 inches
6. Height above grade: 35 feet 6 inches
7. Elevation (side of building or lot where the sign will be erected): NORTH
8. Name of Sign Contractor/Erector: SHAWMUT WOODWORKING AND SUPPLY

To be legal, such sign shall comply with all provisions of Title 17 of the Chicago Municipal Code ("Zoning Ordinance") and all other provisions of the Municipal Code governing the permitting, construction and maintenance and removal of signs and sign structures. Failure of the applicant and the applicant's successors to comply shall be grounds for invalidation or revocation of the sign permit.

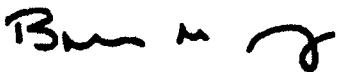

Alderman

42

Ward

C NON-ILLUM. VERTICAL CABINET BLADE SIGN - ELEVATION
Scale: 3/8" = 1' - 0"

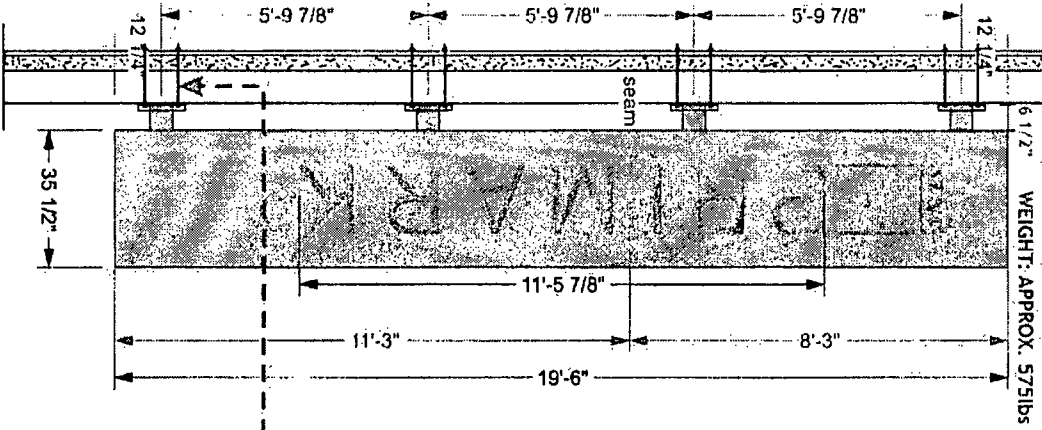

DETAILS

- 1 8" DEEP FABRICATED ALUMINUM PANEL WITH INTERNAL ANGLE FRAME AND ADDED SUPPORT BEAMS, PAINTED TO MATCH RAL 7037.
- 2 1/2" THICK, ROUTED ACETALIC FLAT CUT OUT LETTERS, PAINTED TO MATCH PMS 312C "AQUA". LETTERS ATTACH TO BOTH SIDES OF SIGN BOX WITH STUDS AND W/2 NUT FASTENERS.
- 3 3" x 3" x 1/8" SQ. HSS TUBES TO RUN THROUGH SIGN BOX, AND BE WELDED TO STEEL SADDLES BOLTED INSIDE OF SIGN. 12" x 12" x 1/2" THICK STEEL MOUNTING PLATE WELDED TO WALL SIDE OF TUBE ARMS. ALL PAINTED TO MATCH RAL 7037. 2-PIECE ESCUTCHEON COVER NEEDED TO COVER ALL MOUNTING HARDWARE WHEN INSTALLED.
- 4 SIGN WILL MOUNT FLUSH TO STOREFRONT WALL WITH THRU BOLTS AND FASTENERS WITH 2" (MIN.) CLIPS. (ACCESS BEHIND WALL NEEDED)

FASTENER DETAILS
1/4" DIA. THRU-BOLTS W/
2 x 2 3/8" STEEL ANGLE CLIP
L = 2" (MIN.)

C NON-ILLUM. VERTICAL CABINET BLADE SIGN - SECTION
Scale: N.T.S.

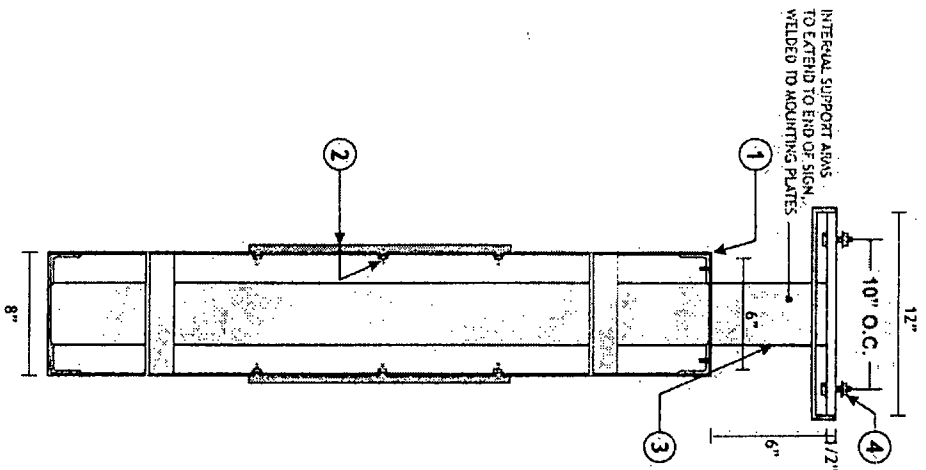

Ruggles SIGN

93 Industry Drive
PO Box 349
Versailles, KY 40383
859.879.1199

MS&S **SI** **MM**

PRIMARK
Store
Space

35 NORTH STATE STREET
CHICAGO, IL 60602

This sign is intended to be installed in accordance with the requirements of Article 600 of the National Electrical Code and/or other applicable local codes. This includes proper grounding and bonding of the sign.

RUGGLES SIGN DOES NOT PROVIDE PRIMARY ELECTRICAL TO SIGN LOCATION!

cULus

Submital Date: 12/20/19
Acct Rep: Aaron Smith
Designer: Heather Hilde

REVISIONS	
1:	5:
2:	6:
3:	7:
4:	8:
5:	9:



CITY OF CHICAGO

DEPARTMENT OF BUILDINGS

Sign Permit Application

APPROVAL NUMBER	APPLICATION NUMBER 100896862	ANNUAL FEE	WORK CODE	DRAWINGS ATTACHED <input type="checkbox"/> YES <input type="checkbox"/> NO																		
DATE OF APPLICATION 10/23/2020		TYPE OF SIGN PROJECTING SIGN <table border="1" style="width:100%; border-collapse: collapse;"> <tr> <td>LENGTH</td> <td>FT 2</td> <td>IN 11</td> <td>HEIGHT</td> <td>FT 19</td> <td>IN. 6</td> </tr> <tr> <td>AREA</td> <td colspan="2">SQ. FT. 57</td> <td>WEIGHT</td> <td colspan="2">LBS 100</td> </tr> <tr> <td colspan="4">SIGN HEIGHT ABOVE GRADE/ROOF</td> <td colspan="2">FT 16</td> </tr> </table>			LENGTH	FT 2	IN 11	HEIGHT	FT 19	IN. 6	AREA	SQ. FT. 57		WEIGHT	LBS 100		SIGN HEIGHT ABOVE GRADE/ROOF				FT 16	
LENGTH	FT 2				IN 11	HEIGHT	FT 19	IN. 6														
AREA	SQ. FT. 57		WEIGHT	LBS 100																		
SIGN HEIGHT ABOVE GRADE/ROOF				FT 16																		
ADDRESS OF SIGN 35 N STATE ST, 60602-																						
BUILDING	ORIGINAL PERMIT NUMBER																					
TYPE OF PERMIT NEW CONSTRUCTION (SIGN)																						
PAYER OF ANNUAL INSPECTION HASNI, MICHAEL 101 ARCH STREET BOSTON, MA 02110 (682)667-5643																						
SIGN MANUFACTURER RUGGLES SIGN																						
ADDRESS WHERE SIGN CAN BE SEEN PRIOR TO ERECTION																						
TICKET NUMBER 0	REINSPECTION CONTROL NUMBER																					
TYPE OF SUPPORT FOR SIGN BEAM																						
SIGN BOARD SUPPORT MEMBERS STEEL																						
ANNUAL FEE _____ CONSTRUCTION FEE <u>200.00</u> 1017 B FEE _____ TOTAL FEE <u>200.00</u> Check # for Zoning AMOUNT PAID <u>200.00</u> Check # for DCAP BALANCE DUE _____																						
NO. OF LAMPS		TOTAL WATTAGE																				
TYPE OF LAMP																						
NO. OF BALLAST/TRANSFORMERS		INPUT OF TRANSFORMERS																				
CONTRACTOR WILL INSTALL		<input checked="" type="checkbox"/> FEEDERS <input checked="" type="checkbox"/> CUSTOMER LEADS																				
TYPE OF SWITCH																						
LOCATION OF SWITCH																						
SIGN LOCATION NON-ILLUMINATED, BUSINESS ID BLADE SIGN OVERHANGING THE PUBLIC WAY, NORTH ELEVATION (E. WASHINGTON FRONTAGE). SIGN STATES "PRIMARK" DIMENSIONS 2'-11.5"L X19'-6"H.																						

The undersigned certify that the statements in this application are true and correct and that all work done under the approved permit will conform to the requirements of the Chicago Municipal Code

	LICENSE # E07040
ELECTRICAL CONTRACTOR GURTZ ELECTRIC COMPANY	ELECTR
ADDRESS 77 W. SEEGER RD. ARLINGTON HEIGHTS, IL 60005	
SUPERVISOR SIGNATURE DocuSigned by: <i>[Signature]</i> 58DD303C0578438	
TGC04940	
CONTRACTOR SHAWMUT WOODWORKING AND SUPPLY	
GENCON	
ADDRESS 560 HARRISON AVENUE BOSTON MA, 02118-	
SIGNATURE DocuSigned by: <i>[Signature]</i> 813816B1343B4FC..	

*IF APPLICABLE

The permit issued on this application will authorize only signs here applied for. If other signs are to be erected they must be covered by additional permits

City of Chicago
Lori E. Lightfoot, Mayor



Department of Buildings
Matthew Beaudet, Commissioner

TYPE OF BUSINESS
COMMERCIAL Other: **RETAIL**
 Name: **PRIMARK**
 LIC #: **468602**
 Renewal Date: _____

Projects Over:
 Private Property
 Public Way Grant Permit #: **1147017**
 Planned Development/Manufacturing PMD/PD#: _____
 Zoning District: **DX** Other: **DX16**

TYPE OF SIGN:
 ADVERTISING ILLUMINATE MOVEABLE
 BUSINESS FLASHING

TOTAL STREET FRONTAGE OF LOT (IN FEET) 260
 TOTAL AREA OF NEW SIGN (SQ.FT.) 57
 TOTAL AREA OF ALL SIGNS ON LOT (SQ.FT.) 264
 HEIGHT OF SIGN ABOVE GRADE (TO TOP) 35ft 6in
 DISTANCE OF CURB LINE OUTER EDGE (ft) 15
 DISTANCE OF STRUCTURE INNER EDGE (ft) 14

DISTANCE FROM (ft):
 A. PUBLIC PARK (OVER 10 ACRES) 5,000
 B. EXPRESSWAY (IF LESS THAN 1,000 FT.) 5,000
 C. RESIDENCE DISTRICT (ADVERTISING SIGNS ONLY) 5,000

IF REPLACEMENT SIGN OR CHANGE OF FACE, WHAT DOES THE EXISTING SIGN READ?

 Original Payee: _____

Landmark Hold: Status: _____

ZONING (OFFICE USE ONLY)

SIGN BOND REQUIRED? YES

COUNCIL ORDER REQUIRED YES

IS SPECIAL PERMISSION REQUIRED FROM CHIEF ELECTRICAL
 YES

IF YES, ATTACH LETTER OF REQUEST

TIME STAMP

SIGN CLERK	APPROVED FOR PERMIT
------------	---------------------

REMARKS



10815 RANCHO BERNARDO RD., SUITE 260
 SAN DIEGO, CA 92198
 PROJECTMANAGER@SULLAWAYENG.COM
 PHONE: 1-858-312-5150 FAX: 1-858-777-3534

PROJECT: PRIMARK, SIGN TYPE: EXTERIOR SIGNAGE, TYPE C, 35 NORTH STATE STREET, CHICAGO, IL
 PROJECT #: 26832C
 CLIENT: RUGGLES SIGN COMPANY

DATE: 07/27/2020
 ENGINEER: ET
 LAST REVISED:

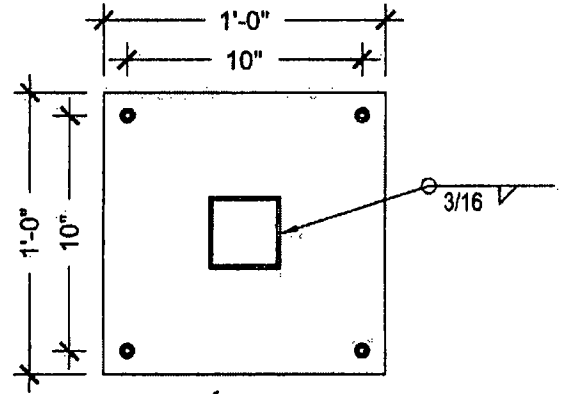
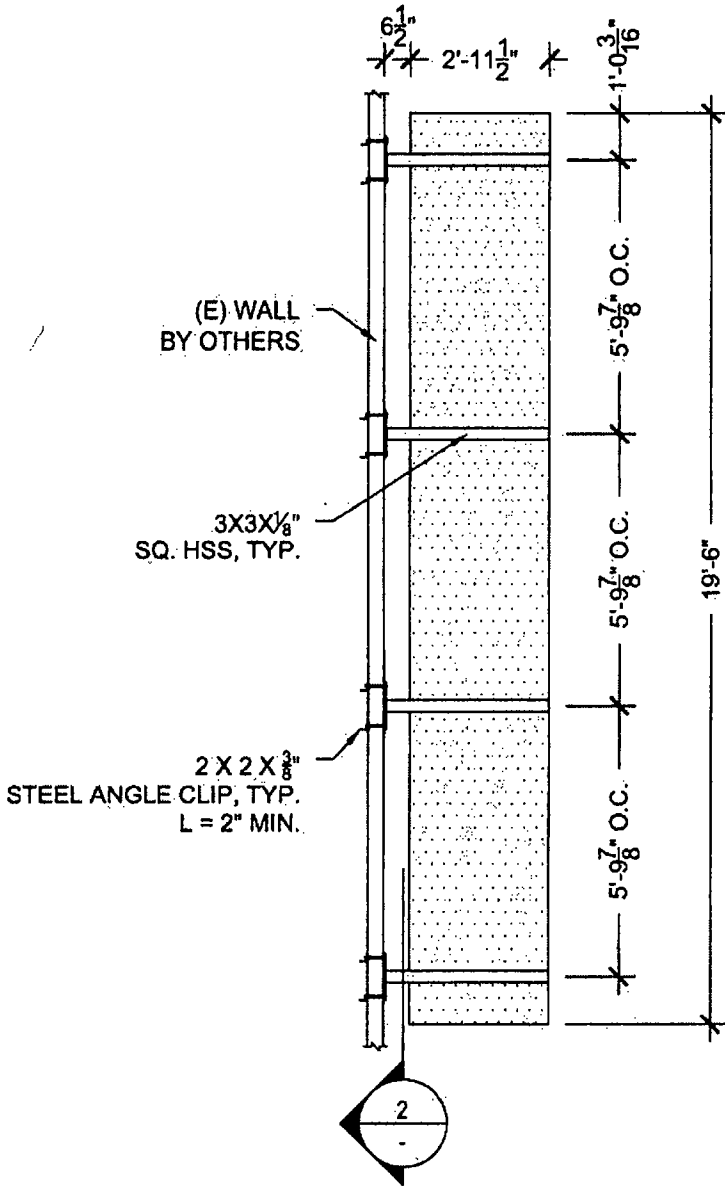

12" X 12" X 1/2" STEEL PLATE
 W/ (4) 1/4" Ø THRU-BOLTS

2 MOUNTING PLATE DETAIL, TYP.

1 FRONT ELEVATION
 MAX. ELEVATION = 45' - 0"

GENERAL NOTES

1. DESIGN CODE: IBC 2018, CHICAGO BUILDING CODE 2019
2. DESIGN LOADS: ASCE 7-16
3. WIND VELOCITY 110 MPH EXPOSURE C
4. SQ. HSS STEEL ASTM A500 GR. B, $F_y = 46$ KSI MIN.
5. PLATE STEEL ASTM A36
6. ANGLE STEEL ASTM A36
7. BOLT STEEL ASTM A307, HDG PER ASTM A153, ZP PER ASTM B633
8. WELDING STRENGTH, $F_{exx} = 70$ KSI
9. PROVIDE PROTECTION AGAINST DISSIMILAR METALS.
10. ALL DIMENSIONS TO BE VERIFIED PRIOR TO FABRICATION
11. ALL EXISTING ELEMENTS AND DIMENSIONS TO BE VERIFIED IN FIELD

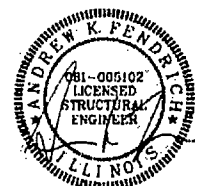

7-30-20
 EXP. 11-30-20



10815 Rancho Bernardo RD., SD, CA 92127
 projectmanager@sullawayeng.com
 Phone: 858-312-5150 Fax: 858-777-3534

PROJECT: PRIMARK, SIGN TYPE: EXTERIOR SIGNAGE, TYPE C

DATE: 7/27/20

PROJ. NO.: 26832C

ENGINEER: ET

CLIENT: RÜGGLES SIGN COMPANY

v5.5

units: pounds, feet unless noted otherwise

Applied Wind Loads; from ASCE 7-16

$P_{net} = \lambda K_{zt} P_{net30}$		(ASCE 30.4-1)
$\lambda =$	1.53	(ASCE Fig. 30.4-1)
$K_{zt} =$	1.0	(unless unusual landscape)
$V =$	110 mph	Exposure = c
Area =	26.0 ft ²	
max. height =	45.0	
$P_{net30} =$	20.51 psf	$P_{net} = 31.38$
$P_{net30} =$	-26.66 psf	$P_{net} = -40.79$

Check 0.25" Dia. Thru Bolts, A307 - Mounting Plate to Wall (LRFD):

$\phi = 0.75$

$P_{net} =$	See Above =	40.79 psf
Governing Tributary Area =	$A_{Trib} = (5'-9.875") * (2'-11.5") + ((6.5") * (3")) =$	17.36 ft ²
Wind Load =	$WL = P_{net} * A_{Trib} =$	0.708 kips
Dead Load =	$DL = 1.2 * 10 \text{psf} * A_{Trib} =$	0.208 kips
arm (WL) =	$(6.5") + (35.5"/2) =$	24.25 in
MWL =	$WL * \text{arm} =$	17.174 k-in
arm (DL) =	$(6.5") + (35.5"/2) =$	24.25 in
MDL =	$DL * \text{arm} =$	5.052 k-in
Spacing =	$Sw =$	10 in
Additional tension due WL =	$TWL = MWL / \text{spacing} / 2 \text{ bolts} =$	0.859 kips
Spacing =	$Sd =$	10 in
Additional tension due DL =	$TDL = MDL / \text{spacing} / 2 \text{ bolts} =$	0.253 kips
#bolts =	=	4 bolts
$T_u =$	$TWL + TDL =$	1.111 kips
$V_u =$	$(WL/2 \text{ bolts}) + (DL/2 \text{ bolts}) =$	0.458 kips
dia. =	=	0.250 in
Abolt =	=	0.049 in ²
$F_{nt} =$	$(0.75 * 60 \text{ksi}) =$	45 ksi
$F_{nv} =$	$(0.45 * 60 \text{ksi}) =$	27 ksi
$\phi T_n =$	$\phi * F_{nt} * A_{bolt} =$	1.657 kips ok
$\phi V_n =$	$\phi * F_{nv} * A_{bolt} =$	0.994 kips ok
$F_v =$	$V_u / A_{bolt} =$	9.336 ksi
$F'_{nt} =$	$1.3 F_{nt} - F_{nt} * F_v / \phi F_{nv} \leq F_{nt} =$	38 ksi
$\phi T_n =$	$\phi * F'_{nt} * A_{bolt} =$	1.390 kips ok



10815 Rancho Bernardo RD., SD, CA 92127
 projectmanager@sullawayeng.com
 Phone: 858-312-5150 Fax: 858-777-3534

PROJECT: PRIMARK, SIGN TYPE: EXTERIOR SIGNAGE, TYPE C
 PROJ. NO.: 26832C
 CLIENT: RUGGLES SIGN COMPANY

DATE: 7/27/20
 ENGINEER: ET

VS.5

units: pounds, feet unless noted otherwise

Check for Loads on 3x3x1/8" Sq. Hss (LRFD):

MWL=	(See Page #2)=	17.174 k-in
MDL=	(See Page #2)=	5.0522 k-in
Total Moment=	Mu=MWL+MDL=	1.852 k-ft
Moment Capacity=	ϕ Mn=	4.82 k-ft
Ratio=	Mu/ ϕ Mn=	0.3843 <1 OK

Check 12x12x0.5" Steel Mounting Plate, A36:

arm =	3.5750 in	b =	12.00 in	t =	0.5 in
Mplate =	Max((2*TWL+TDL),(2*TDL+TWL))* arm =		7.043 k-in	(TWL & TDL,	
Z=	bt ² /4=		0.750 in ³	See Page #2)	
ϕ Mn=	ϕ *Fy*Z=0.9*36ksi*Z=		16.875 k-in	OK	

Check 2x2x0.375" Steel Angle, A36 for Leg Bending:

arm =	1.0000 in	b =	2.00 in	t =	0.375 in
Mplate =	T per bolt*arm =		1.111 k-in	(For T, See Page #2)	
Z=	bt ² /4=		0.070 in ³		
ϕ Mn=	ϕ *Fy*Z=0.9*36ksi*Z=		2.278 k-in	OK	