



# City of Chicago



Or2021-114

Office of the City Clerk

## Document Tracking Sheet

<b>Meeting Date:</b>	5/26/2021
<b>Sponsor(s):</b>	Sadlowski Garza (10)
<b>Type:</b>	Order
<b>Title:</b>	Issuance of permits for sign(s)/signboard(s) at 9226 S Commercial Ave
<b>Committee(s) Assignment:</b>	Committee on Zoning, Landmarks and Building Standards

**CITY COUNCIL  
COMMITTEE ON ZONING, LANDMARKS AND BUILDING STANDARDS**

**COUNCIL ORDER**

**RE:** Approval of sign over 100 square feet in area or over 24 feet above grade

**ORDERED,** that the City Council hereby approves the following sign application submitted by:

**Applicant\*:** Leonard S. Swajkowski

(\* The Applicant is the owner of the real property or the business tenant of the real property. Do not list the sign contractor, sign erector, sign company or advertising entity in the above space.)

This Order approves the following sign in accordance with Municipal Code of Chicago Section 13-20-680:

**Address of Sign:** 9226 S. Commerical ave Chicago, IL 60617

**Zoning District:** B3-2

**DOB Sign Permit Application #:** 100909243, 100909240, 100909232

**Sign Details:**

1. On-premise X OR Off-premise       

2. Static sign X OR Dynamic-image display sign       

3. Number of sign faces 3

4. Projecting over the public way YES (Yes or No) If yes, Public Way Use #: 1147811

5. Dimensions: Length 20 feet 0 inches Height 3 feet 9 inches

Total square feet in area: 78 feet 0 inches

6. Height above grade: 26 feet 0 inches

7. Elevation (side of building or lot where the sign will be erected): North- East- South

8. Name of Sign Contractor/Erector: The Holland Design Group Inc

To be legal, such sign shall comply with all provisions of Title 17 of the Chicago Municipal Code ("Zoning Ordinance") and all other provisions of the Municipal Code governing the permitting, construction and maintenance and removal of signs and sign structures. Failure of the applicant and the applicant's successors to comply shall be grounds for invalidation or revocation of the sign permit.

Swan Sadlowski Haya  
Alderman

10  
Ward

5/17/21

92161 commercial ave chicago il

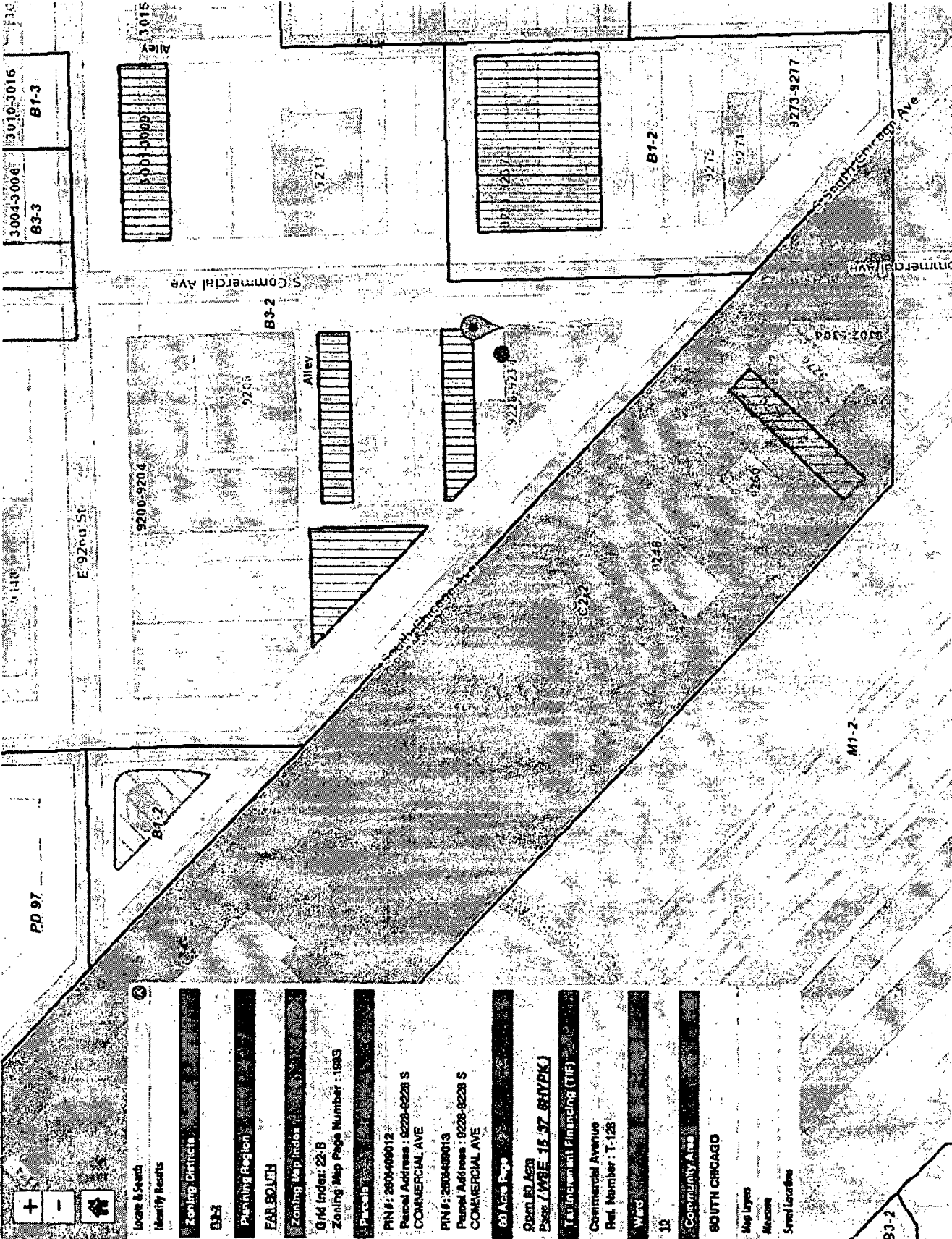

**Locate & Search**

Identify Results

**Zoning Districts**

B3-2

**Planning Region**

FAR SOUTH

**Zoning Map Index**

Grid Index: 22-B

Zoning Map Page Number: 1983

**Parcel**

PN# : 2603-00012

Parcel Address : 9228-9228 S

COMMERCIAL AVE

PN# : 2603-00013

Parcel Address : 9228-9228 S

COMMERCIAL AVE

**80 Acres Page**

Open to Area

Parcel / WSE 18 37 847PKJ

**Tax Increment Financing (TIF)**

Commercial Avenue

Ref. Number : T-128

**WCS**

10

**Community Area**

SOUTH CHICAGO

**Map Layers**

Map

Measure

Street Locations

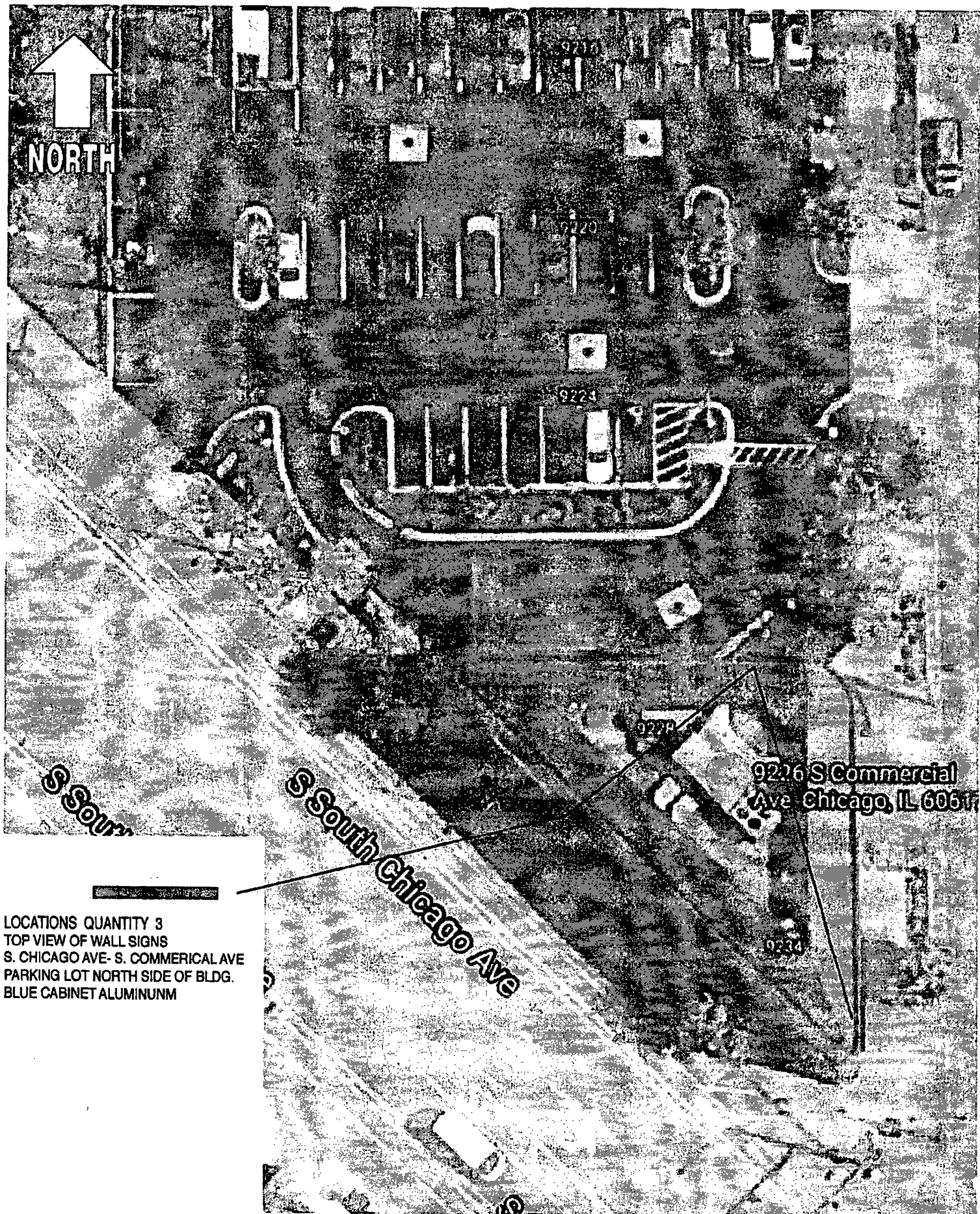

LOCATIONS QUANTITY 3  
TOP VIEW OF WALL SIGNS  
S. CHICAGO AVE- S. COMMERCIAL AVE  
PARKING LOT NORTH SIDE OF BLDG.  
BLUE CABINET ALUMINUM

9226 S Commercial Ave Chicago, IL



Locate & Select

Locality Results

Zoning Districts

83-2

Planning Region

EARLSOUTH

Zoning Map Index

GRID Index: 22-8

Zoning Map Page Number: 1985

Parcel

PIN #: 2606409012

Parcel Address: 9226-9228 S

COMMERCIAL AVE

PIN #: 2606409013

Parcel Address: 9228-9228 S

COMMERCIAL AVE

PIN #: 2606409012

Parcel Address: 9228-9228 S

COMMERCIAL AVE

PIN #: 2606409013

Parcel Address: 9228-9228 S

COMMERCIAL AVE

Building Address

9226 S COMMERCIAL AVE (887402)

9228 S COMMERCIAL AVE (887402)

GO (Use Page)

Open ID AVE

Page (WSE 15 37 81YPK)

Open ID AVE

Page (WSE 15 37 81YPK)

Additional Financing (TIF)

Commercial Avenue

Ref. Number: T-128

Ward

10

Community Area

SOUTH CHICAGO

Map Layers



9209-9214

9205

Alley



LOT

PARKING LOT

Alley

STREET FRONT 269.0'

9228-9234

88.0'

120.0'

269.0'

269.0'

SIDEWALK

9248

9228-9234

269.0'

269.0'

269.0'

9275

9228-9234

269.0'

269.0'

269.0'

9275

9228-9234

269.0'

269.0'

269.0'

9275

9228-9234

269.0'

269.0'

269.0'

9275

9228-9234

269.0'

269.0'

269.0'

9275

9228-9234

269.0'

269.0'

269.0'

9275

9228-9234

269.0'

269.0'

269.0'

9275

9228-9234

269.0'

269.0'

269.0'

9275

9228-9234

269.0'

269.0'

269.0'

9275

9228-9234

269.0'

269.0'

269.0'

9275

9228-9234

269.0'

269.0'

269.0'

9275

9228-9234

269.0'

269.0'

269.0'

9275

9228-9234

269.0'

269.0'

269.0'

9275

9228-9234

269.0'

269.0'

269.0'

9275

9228-9234

269.0'

269.0'

269.0'

9275

9228-9234

269.0'

269.0'

269.0'

9275

9228-9234

269.0'

269.0'

269.0'

9275

9228-9234

269.0'

269.0'

269.0'

9275

9228-9234

269.0'

269.0'

269.0'

9275

9228-9234

269.0'

269.0'

269.0'

9275

9228-9234

269.0'

269.0'

269.0'

9275

9228-9234

269.0'

269.0'

269.0'

9275

9228-9234

269.0'

269.0'

269.0'

9275

9228-9234

269.0'

269.0'

269.0'

9275

9228-9234

269.0'

269.0'

269.0'

9275

9228-9234

269.0'

269.0'

269.0'

9275

9228-9234

269.0'

269.0'

269.0'

9275

9228-9234

269.0'

269.0'

269.0'

9275

9228-9234

269.0'

269.0'

269.0'

9275

9228-9234

269.0'

269.0'

269.0'

9275

9228-9234

269.0'

269.0'

269.0'

9275

9228-9234

269.0'

269.0'

269.0'

9275

9228-9234

269.0'

269.0'

269.0'

9275

9228-9234

269.0'

269.0'

269.0'

9275

9228-9234

269.0'

269.0'

269.0'

9275

9228-9234

269.0'

269.0'

269.0'

9275

9228-9234

269.0'

269.0'

269.0'

9275

9228-9234

269.0'

269.0'

269.0'

9275

9228-9234

269.0'

269.0'

269.0'

9275

9228-9234

269.0'

269.0'

269.0'

9275

9228-9234

269.0'

269.0'

269.0'

9275

9228-9234

269.0'

269.0'

269.0'

9275

9228-9234

269.0'

269.0'

269.0'

9275

9228-9234

269.0'

269.0'

269.0'

9275

9228-9234

269.0'

269.0'

269.0'

9275

9228-9234

269.0'

269.0'

269.0'

9275

9228-9234

269.0'