



City of Chicago



O2021-3720

Office of the City Clerk

Document Tracking Sheet

Meeting Date:	9/14/2021
Sponsor(s):	O'Shea (19)
Type:	Ordinance
Title:	Vacation of public alley(s) in area bounded by W Chelsea Pl, S Vincennes Ave, W Monterey Ave and S Esmond St
Committee(s) Assignment:	Committee on Transportation and Public Way

INTERGOVERNMENTAL VACATION ORDINANCE

WHEREAS, the City of Chicago ("City") is a home rule unit of local government pursuant to Article VII, Section 6 (a) of the 1970 Constitution of the State of Illinois and, as such, may exercise any power and perform any function pertaining to its government and affairs; and

WHEREAS, the properties at 11001-11059 S. Church Street, 11042-11128 S. Vincennes Avenue, 1649-1661 W. Chelsea Place, 1631-1645 W. Chelsea Place, 1700-1714 W. Pryor Avenue and 1718-1730 W. Pryor Avenue; together with 11102-11128 S. Hermosa Avenue, 11132-11144 S. Hermosa Avenue, and 1800-1810 W. Monterey Avenue, all in Chicago, Illinois, are owned by the City of Chicago, an Illinois municipal corporation, In Trust for the Use of Schools, for the benefit and use of the Board of Education of the City of Chicago, a body politic and corporate (such Board of Education, hereinafter referred to as the "Chicago Public Schools"); and

WHEREAS, the properties at 1810-1812 W. Monterey Avenue are owned by Neighborspace, which has agreed to quitclaim its interests in the adjacent to-be-vacated alley to the City of Chicago in Trust for the Use of Schools prior to finalization of the vacation; and

WHEREAS, the subject vacation areas have been constructed over by the Chicago Public Schools as part of the athletic field and parking lot serving Morgan Park High School; and

WHEREAS, the City Council of the City of Chicago, after due investigation and consideration, has determined that the nature and extent of public use and the public interest to be subserved is such as to warrant the vacations of the public alleys described below; now, therefore,

BE IT ORDAINED BY THE CITY COUNCIL OF THE CITY OF CHICAGO:

SECTION 1.

EXHIBIT A Legal Description (larger area)

ALL OF THE NORTHERLY-SOUTHERLY 16-FOOT-WIDE PUBLIC ALLEY IN BLOCK 47 OF WASHINGTON HEIGHTS, BEING A RESUBDIVISION ACCORDING TO THE PLAT THEREOF RECORDED ON JUNE 27, 1872 AS DOCUMENT NUMBER 39778, IN THE EAST HALF OF THE SOUTHEAST QUARTER OF SECTION 18 AND THE EAST HALF OF THE NORTHEAST QUARTER OF SECTION 19, ALL IN TOWNSHIP 37 NORTH, RANGE 14 EAST OF THE THIRD PRINCIPAL MERIDIAN, SAID NORTHERLY-SOUTHERLY ALLEY LYING SOUTH OF AND ADJOINING THE SOUTHERLY RIGHT OF WAY OF W. CHELSEA PLACE; LYING NORTH OF AND ADJOINING THE NORTHERLY RIGHT OF WAY OF W. PRYOR AVENUE; LYING WEST OF AND ADJOINING THE WESTERLY LOT LINE OF LOTS 1

THROUGH 24 AND LYING EAST OF AND ADJOINING THE EASTERLY LOT LINE OF LOTS 25 THROUGH 48 IN SAID BLOCK 47; ALL IN COOK COUNTY, ILLINOIS, SAID ABOVE DESCRIBED PARCEL CONTAINING 9,619.59 SQUARE FEET OR 0.22 ACRES, MORE OR LESS, as shaded and legally described by the words "HEREBY VACATED" on the plat hereto attached as EXHIBIT A, which drawing for greater clarity, is hereby made a part of this ordinance.

Together with:

EXHIBIT B Legal Description (smaller area)

THAT PART OF THE EASTERLY-WESTERLY 16-FOOT-WIDE PUBLIC ALLEY LYING SOUTH OF AND ADJOINING LOT 12 IN BLOCK 53 OF WASHINGTON HEIGHTS, BEING A RESUBDIVISION ACCORDING TO THE PLAT THEREOF RECORDED ON JUNE 27, 1872, AS DOCUMENT NUMBER 39778, IN THE WEST HALF OF THE NORTHEAST QUARTER OF SECTION 19, TOWNSHIP 37 NORTH, RANGE 14 EAST OF THE THIRD PRINCIPAL MERIDIAN, LYING EAST OF AND ADJOINING THE SOUTHERLY EXTENSION OF THE WEST LINE OF SAID LOT 12 TO THE INTERSECTION WITH THE NORTH LINE OF LOT 18 IN SAID BLOCK 53; LYING NORTH OF AND ADJOINING LOTS 13 THROUGH 17 AND THAT PART OF LOT 18 IN SAID BLOCK 53 AND LYING WEST OF AND ADJOINING THE WEST RIGHT OF WAY OF S. HERMOSA AVENUE; ALL IN COOK COUNTY, ILLINOIS, SAID ABOVE DESCRIBED PARCEL CONTAINING 2,406.46 SQUARE FEET OR 0.06 ACRES, MORE OR LESS, as shaded and legally described by the words "HEREBY VACATED" on the plat hereto attached as EXHIBIT B, which drawing for greater clarity, is hereby made a part of this ordinance, and the areas depicted in the plats attached as Exhibits A and B are hereby vacated and closed, inasmuch as the same is no longer required for public use and the public interest will be subserved by such vacations.

SECTION 2. The vacations herein provided for are made upon the express condition that within one hundred eighty (180) days after the passage of this ordinance, the Chicago Public Schools or its assign shall file or cause to be filed for recordation with the Office of the Clerk of Cook County, Illinois, Recordings Division, a certified copy of this ordinance, together with the associated full-sized plats as approved by the Department of Transportation's Superintendent of Maps and Plats.

SECTION 3. This ordinance shall take effect and be in force from and after its passage and publication. The vacations shall take effect and be in force from and after the recording of this ordinance and the approved plats of vacation.

Vacations Approved:

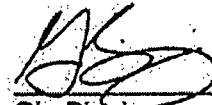

Gia Blagi
Commissioner
Department of Transportation

Approved as to Form and Legality

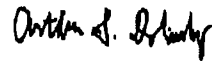

Arthur Dolinsky
Senior Counsel

Introduced By:



Honorable Matt O'Shea
Alderman, 19th Ward

THEY ARE THE ONLY PERSONS KNOWN TO HAVE BEEN IN CONTACT WITH THE SUBJECT AND HIS WIFE IN THE PERIOD OF HIS MARRIAGE. THE SUBJECT'S MOTHER, MRS. J. M. BROWN, IS A RESIDENT OF THE CITY OF NEW YORK, AND IS THE ONLY PERSON KNOWN TO HAVE BEEN IN CONTACT WITH THE SUBJECT AND HIS WIFE IN THE PERIOD OF HIS MARRIAGE. THE SUBJECT'S MOTHER, MRS. J. M. BROWN, IS A RESIDENT OF THE CITY OF NEW YORK, AND IS THE ONLY PERSON KNOWN TO HAVE BEEN IN CONTACT WITH THE SUBJECT AND HIS WIFE IN THE PERIOD OF HIS MARRIAGE.

DATE: 01-01-2017
 FROM: NORTH AFRICA
 TO: SOUTH AFRICA
 SUBJECT: SOUTH AFRICA

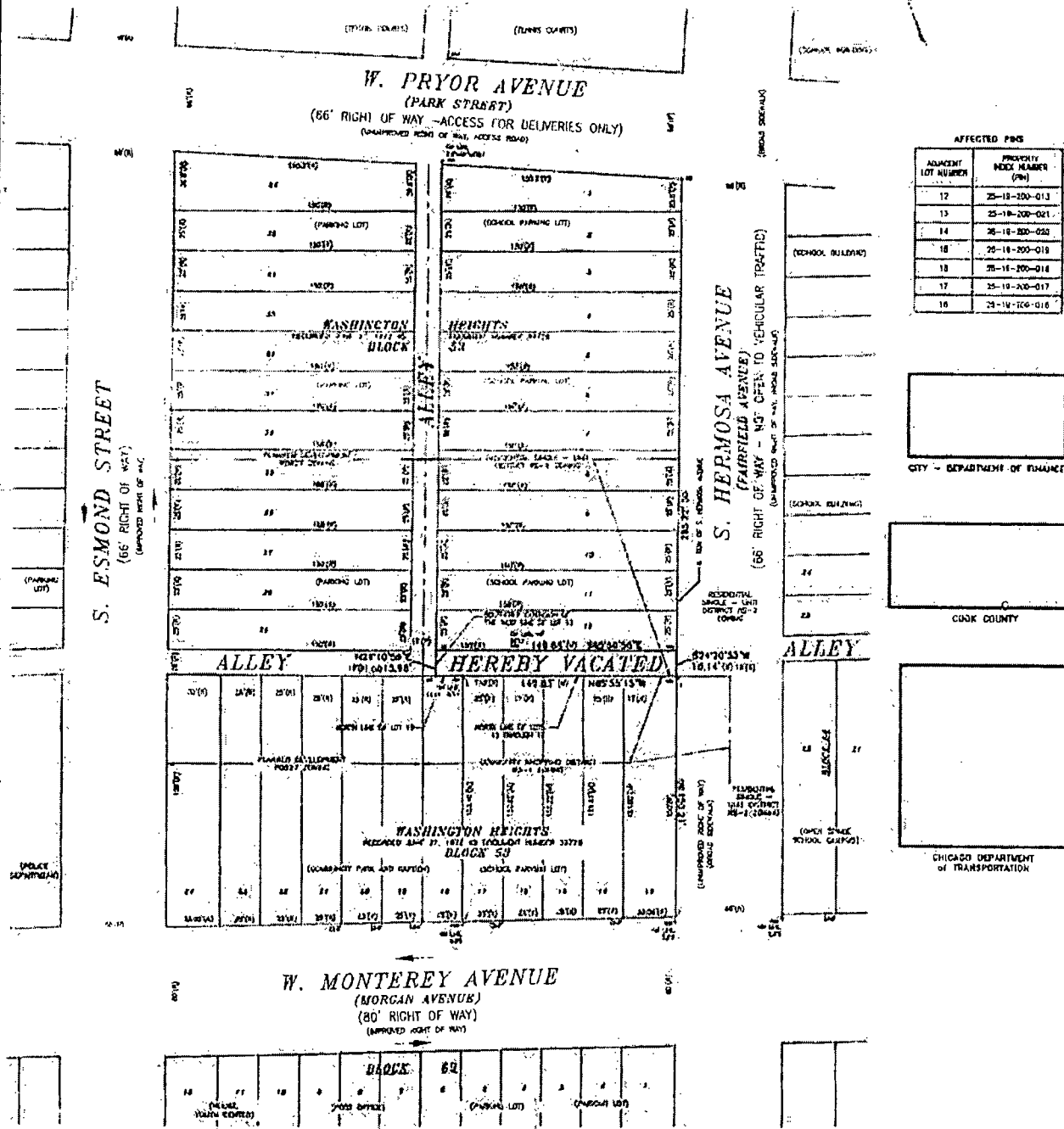

SUBJECTS:

1. THE MARKET WAS CALLED IN THE FIELD ON MARCH 13, 1955.
2. ALL RECORDS AND MODE OF BUY AND SELL SHOWS AN AVERAGE OF 10% OF THE MARKET OF THE MARKET. RECORDS AND AVERAGE OF 10% OF THE MARKET OF THE MARKET. RECORDS AND AVERAGE OF 10% OF THE MARKET OF THE MARKET.
3. RECORDS AND MODE OF BUY AND SELL SHOWS AN AVERAGE OF 10% OF THE MARKET OF THE MARKET. RECORDS AND AVERAGE OF 10% OF THE MARKET OF THE MARKET.
4. RECORDS AND MODE OF BUY AND SELL SHOWS AN AVERAGE OF 10% OF THE MARKET OF THE MARKET. RECORDS AND AVERAGE OF 10% OF THE MARKET OF THE MARKET.
5. RECORDS AND MODE OF BUY AND SELL SHOWS AN AVERAGE OF 10% OF THE MARKET OF THE MARKET. RECORDS AND AVERAGE OF 10% OF THE MARKET OF THE MARKET.
6. RECORDS AND MODE OF BUY AND SELL SHOWS AN AVERAGE OF 10% OF THE MARKET OF THE MARKET. RECORDS AND AVERAGE OF 10% OF THE MARKET OF THE MARKET.
7. RECORDS AND MODE OF BUY AND SELL SHOWS AN AVERAGE OF 10% OF THE MARKET OF THE MARKET. RECORDS AND AVERAGE OF 10% OF THE MARKET OF THE MARKET.
8. RECORDS AND MODE OF BUY AND SELL SHOWS AN AVERAGE OF 10% OF THE MARKET OF THE MARKET. RECORDS AND AVERAGE OF 10% OF THE MARKET OF THE MARKET.
9. RECORDS AND MODE OF BUY AND SELL SHOWS AN AVERAGE OF 10% OF THE MARKET OF THE MARKET. RECORDS AND AVERAGE OF 10% OF THE MARKET OF THE MARKET.
10. RECORDS AND MODE OF BUY AND SELL SHOWS AN AVERAGE OF 10% OF THE MARKET OF THE MARKET. RECORDS AND AVERAGE OF 10% OF THE MARKET OF THE MARKET.

218.2021
LOCATION EXHIBIT

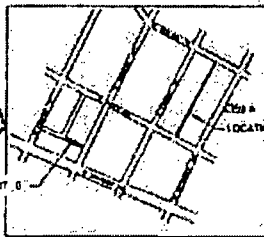

STATE OF ILLINOIS)
)SS
COUNTY OF COOK)

3. The above information was obtained from a review of the files of the FBI, New York Office, and the files of the FBI, New York Office, and the files of the FBI, New York Office.

THE UNIVERSITY OF CHICAGO PRESS
50 EAST LEXINGTON AVENUE
NEW YORK, N.Y. 10017

1. NAME _____
 2. ADDRESS _____
 3. CITY _____
 4. STATE _____
 5. ZIP _____
 6. PHONE _____
 7. DATE _____
 8. SIGNATURE _____
 9. PRINT NAME _____
 10. PRINT ADDRESS _____
 11. PRINT CITY _____
 12. PRINT STATE _____
 13. PRINT ZIP _____
 14. PRINT PHONE _____
 15. PRINT DATE _____
 16. PRINT SIGNATURE _____
 17. PRINT NAME _____
 18. PRINT ADDRESS _____
 19. PRINT CITY _____
 20. PRINT STATE _____
 21. PRINT ZIP _____
 22. PRINT PHONE _____
 23. PRINT DATE _____
 24. PRINT SIGNATURE _____
 25. PRINT NAME _____
 26. PRINT ADDRESS _____
 27. PRINT CITY _____
 28. PRINT STATE _____
 29. PRINT ZIP _____
 30. PRINT PHONE _____
 31. PRINT DATE _____
 32. PRINT SIGNATURE _____
 33. PRINT NAME _____
 34. PRINT ADDRESS _____
 35. PRINT CITY _____
 36. PRINT STATE _____
 37. PRINT ZIP _____
 38. PRINT PHONE _____
 39. PRINT DATE _____
 40. PRINT SIGNATURE _____
 41. PRINT NAME _____
 42. PRINT ADDRESS _____
 43. PRINT CITY _____
 44. PRINT STATE _____
 45. PRINT ZIP _____
 46. PRINT PHONE _____
 47. PRINT DATE _____
 48. PRINT SIGNATURE _____
 49. PRINT NAME _____
 50. PRINT ADDRESS _____
 51. PRINT CITY _____
 52. PRINT STATE _____
 53. PRINT ZIP _____
 54. PRINT PHONE _____
 55. PRINT DATE _____
 56. PRINT SIGNATURE _____
 57. PRINT NAME _____
 58. PRINT ADDRESS _____
 59. PRINT CITY _____
 60. PRINT STATE _____
 61. PRINT ZIP _____
 62. PRINT PHONE _____
 63. PRINT DATE _____
 64. PRINT SIGNATURE _____
 65. PRINT NAME _____
 66. PRINT ADDRESS _____
 67. PRINT CITY _____
 68. PRINT STATE _____
 69. PRINT ZIP _____
 70. PRINT PHONE _____
 71. PRINT DATE _____
 72. PRINT SIGNATURE _____
 73. PRINT NAME _____
 74. PRINT ADDRESS _____
 75. PRINT CITY _____
 76. PRINT STATE _____
 77. PRINT ZIP _____
 78. PRINT PHONE _____
 79. PRINT DATE _____
 80. PRINT SIGNATURE _____
 81. PRINT NAME _____
 82. PRINT ADDRESS _____
 83. PRINT CITY _____
 84. PRINT STATE _____
 85. PRINT ZIP _____
 86. PRINT PHONE _____
 87. PRINT DATE _____
 88. PRINT SIGNATURE _____
 89. PRINT NAME _____
 90. PRINT ADDRESS _____
 91. PRINT CITY _____
 92. PRINT STATE _____
 93. PRINT ZIP _____
 94. PRINT PHONE _____
 95. PRINT DATE _____
 96. PRINT SIGNATURE _____
 97. PRINT NAME _____
 98. PRINT ADDRESS _____
 99. PRINT CITY _____
 100. PRINT STATE _____
 101. PRINT ZIP _____
 102. PRINT PHONE _____
 103. PRINT DATE _____
 104. PRINT SIGNATURE _____
 105. PRINT NAME _____
 106. PRINT ADDRESS _____
 107. PRINT CITY _____
 108. PRINT STATE _____
 109. PRINT ZIP _____
 110. PRINT PHONE _____
 111. PRINT DATE _____
 112. PRINT SIGNATURE _____
 113. PRINT NAME _____
 114. PRINT ADDRESS _____
 115. PRINT CITY _____
 116. PRINT STATE _____
 117. PRINT ZIP _____
 118. PRINT PHONE _____
 119. PRINT DATE _____
 120. PRINT SIGNATURE _____
 121. PRINT NAME _____
 122. PRINT ADDRESS _____
 123. PRINT CITY _____
 124. PRINT STATE _____
 125. PRINT ZIP _____
 126. PRINT PHONE _____
 127. PRINT DATE _____
 128. PRINT SIGNATURE _____
 129. PRINT NAME _____
 130. PRINT ADDRESS _____
 131. PRINT CITY _____
 132. PRINT STATE _____
 133. PRINT ZIP _____
 134. PRINT PHONE _____
 135. PRINT DATE _____
 136. PRINT SIGNATURE _____
 137. PRINT NAME _____
 138. PRINT ADDRESS _____
 139. PRINT CITY _____
 140. PRINT STATE _____
 141. PRINT ZIP _____
 142. PRINT PHONE _____
 143. PRINT DATE _____
 144. PRINT SIGNATURE _____
 145. PRINT NAME _____
 146. PRINT ADDRESS _____
 147. PRINT CITY _____
 148. PRINT STATE _____
 149. PRINT ZIP _____
 150. PRINT PHONE _____
 151. PRINT DATE _____
 152. PRINT SIGNATURE _____
 153. PRINT NAME _____
 154. PRINT ADDRESS _____
 155. PRINT CITY _____
 156. PRINT STATE _____
 157. PRINT ZIP _____
 158. PRINT PHONE _____
 159. PRINT DATE _____
 160. PRINT SIGNATURE _____
 161. PRINT NAME _____
 162. PRINT ADDRESS _____
 163. PRINT CITY _____
 164. PRINT STATE _____
 165. PRINT ZIP _____
 166. PRINT PHONE _____
 167. PRINT DATE _____
 168. PRINT SIGNATURE _____
 169. PRINT NAME _____
 170. PRINT ADDRESS _____
 171. PRINT CITY _____
 172. PRINT STATE _____
 173. PRINT ZIP _____
 174. PRINT PHONE _____
 175. PRINT DATE _____
 176. PRINT SIGNATURE _____
 177. PRINT NAME _____
 178. PRINT ADDRESS _____
 179. PRINT CITY _____
 180. PRINT STATE _____
 181. PRINT ZIP _____
 182. PRINT PHONE _____
 183. PRINT DATE _____
 184. PRINT SIGNATURE _____
 185. PRINT NAME _____
 186. PRINT ADDRESS _____
 187. PRINT CITY _____
 188. PRINT STATE _____
 189. PRINT ZIP _____
 190. PRINT PHONE _____
 191. PRINT DATE _____
 192. PRINT SIGNATURE _____
 193. PRINT NAME _____
 194. PRINT ADDRESS _____
 195. PRINT CITY _____
 196. PRINT STATE _____
 197. PRINT ZIP _____
 198. PRINT PHONE _____
 199. PRINT DATE _____
 200. PRINT SIGNATURE _____
 201. PRINT NAME _____
 202. PRINT ADDRESS _____
 203. PRINT CITY _____
 204. PRINT STATE _____
 205. PRINT ZIP _____
 206. PRINT PHONE _____
 207. PRINT DATE _____
 208. PRINT SIGNATURE _____
 209. PRINT NAME _____
 210. PRINT ADDRESS _____
 211. PRINT CITY _____
 212. PRINT STATE _____
 213. PRINT ZIP _____
 214. PRINT PHONE _____
 215. PRINT DATE _____
 216. PRINT SIGNATURE _____
 217. PRINT NAME _____
 218. PRINT ADDRESS _____
 219. PRINT CITY _____
 220. PRINT STATE _____

CDOT # 18/19-19-21-3975

[illegible]

PREPARED FOR:
CHICAGO BOARD OF EDUCATION
OF W. JACKSON AVE.
CHICAGO, ILLINOIS

MAIL TO:
60311 N. BRISTOL ST.
ALH: & LEWIS, INC.
29 S. CLARK ST. SUITE 2000
CHICAGO, ILLINOIS

1-800-368-2222	1-800-368-2222	1-800-368-2222	1-800-368-2222
----------------	----------------	----------------	----------------

PLAT of VACATION	RECEIVED 20702
	SHEET 1